



*Reinventing The Window & Door Industry*

# THE COLLECTION

ENTRANCE DOORS

STACKING DOORS

MOVABLE WALLS

SLIDING DOORS

WINDOWS

MANUFACTURERS  
INTRODUCTION



# CONTENTS

## THE RHINO TRUSION

INTRODUCTION	3
THE RANGE	5
FLEXIBILITY	6
MATERIAL OPTIONS	7
SIMPLICITY	8

## DESIGN FEATURES

SIGHTLINES	9
SECURITY	11
EFFICIENCY	12

## ENTRANCE DOORS

SWING DOORS	13
CAD DETAIL	14
PIVOT DOORS	16
CAD DETAIL	17

## STACKING DOORS

APPLICATIONS	18
PRODUCTS	19
CONFIGURATIONS	22
FOLDING OPTIONS	23
CAD DETAILS	24
CORNER OPTIONS	25
THRESHOLDS	27
FRAMELESS DOORS	28
OPERABLE SCREENS	29

## STYLISH SLIDERS

INTRODUCTION	30
TRACK OPTIONS	31
MULTI SLIDERS	32
SIGHTLINES	33
POCKET DOORS	34
SINGLE TRACK	35
CAD DETAILS	36

## WINDOWS

BI-FOLD WINDOWS	37
FLUSH CASEMENT WINDOWS	39
PICTURE WINDOWS	41



## MOVABLE WALLS

PRODUCTS	42
CAD DETAILS	43

## APPENDIX

GLASS	44
MEASURING	45
BIFOLD INSTALLATION	46
SLIDER INSTALLATION	47
MANUFACTURING PRINCIPLE	48
DRAINAGE	49
PROFILE OVERVIEW	51
HARDWARE OVERVIEW	52
RHINOLINQ SOFTWARE	53

**PIONEERING SOLUTIONS**  
Market-Ready Innovation

Rhinotrusion is redefining how modern window and door systems are built. We supply advanced composite profiles engineered for superior strength, thermal efficiency, and design flexibility—helping manufacturers meet modern architectural and performance demands.

Our platform delivers:

- **High-performance composite material science**
- **Scalable, production-ready system profiles**
- **Future-proof designs aligned with evolving codes**

For manufacturers, joining the RHINOCRASH Network provides a clear competitive edge—expanded product capability, stronger differentiation, and new revenue potential.



# THE RHINO TRUSION





# THE RHINO TRUSION

## WHERE INNOVATION MEETS UNBEATABLE FLEXIBILITY

FLEXIBILITY

Constructing custom doors and windows for your clients has never been more effortless, thanks to Rhinotrusion's diverse and flexible profiles.

Our profiles are tailored to provide a seamless integration of aesthetics and functionality, allowing you to easily pivot between different client requirements.

Whether you envision dual colors or wish to blend contrasting wood finishes inside and out, our profiles are engineered to make your design aspirations a reality.

## UNIFIED PROFILES ACROSS ALL SYSTEMS, DELIVERING A SEAMLESS VISUAL MATCH

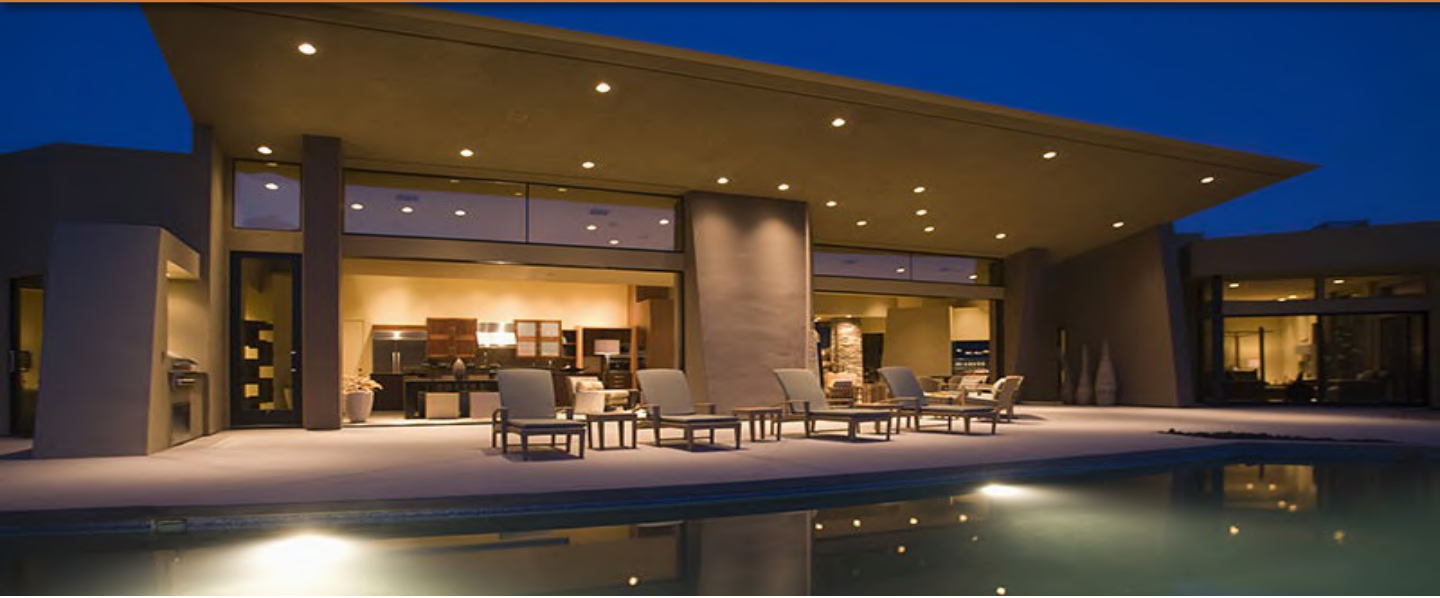

RT7550 AA  
SASH DEPTH  
75mm x 50mm  
3" x 2"±

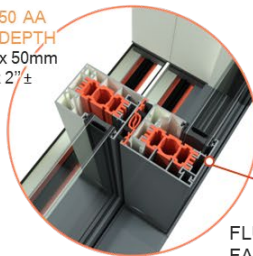

FLUSH  
FACE

RT9050 AW  
SASH DEPTH  
90mm x 50mm  
3½" x 2"±

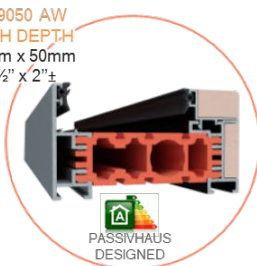

PASSIVHAUS  
DESIGNED

DUAL  
COLOR

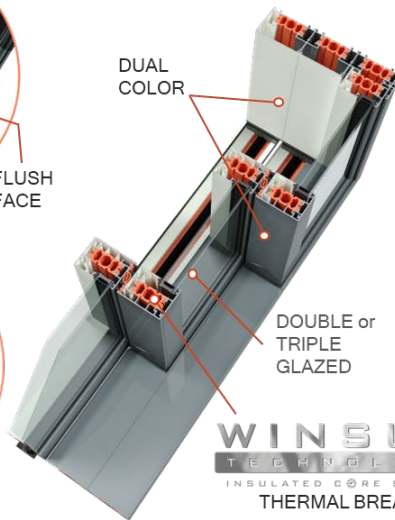

DOUBLE or  
TRIPLE  
GLAZED

WINSUL  
TECHNOLOGY  
INSULATED CORE SYSTEM  
THERMAL BREAK

## MATCHING PROFILES



All of our door and window profiles match across the range. The manufacturing process of all of our materials is relatively the same.

# THE RHINO TRUSION



RT7550 AA  
Aluminum



RT7550 AW  
Aluminum & Wood



RT7550 WW  
Wood



RT7550 CW  
Contemporary Wood

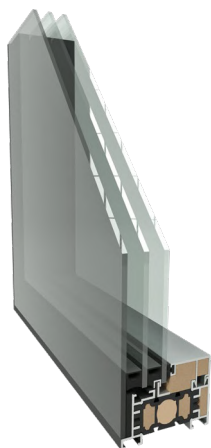
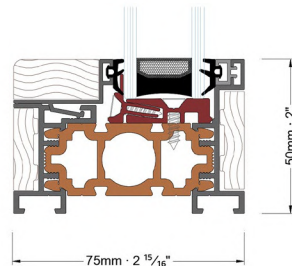
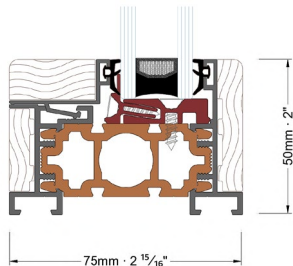
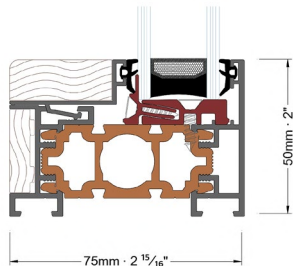
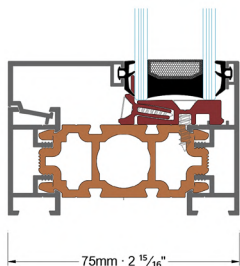

RT7550 AG  
Aluminum & GlassIIEdge™

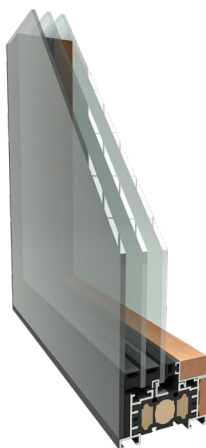

RT7550 WG  
Wood & GlassIIEdge™



RT7650 PT  
Aluminum

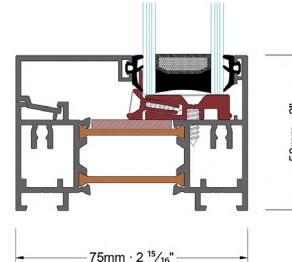
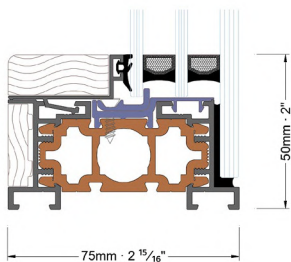
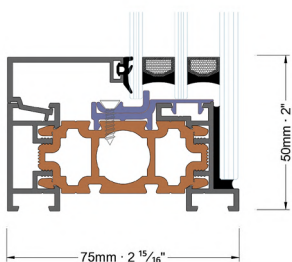

# THE RHINO TRUSION

SIMPLICITY

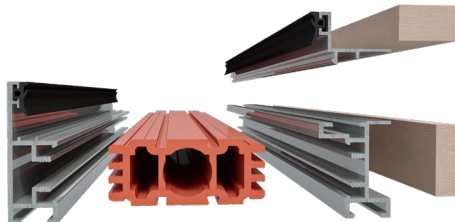

### FLEXIBILITY & CHOICE

Rhinotrusion provides an impressive range of windows & doors around a single core.

### EASE OF MANUFACTURING

1. Assemble profile.
2. Cut to length.
3. Drill and machine.
4. Connect the corners.

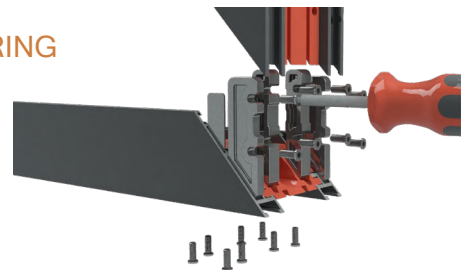

### MATCHING PROFILES

All of our door and window profiles match across the range. The manufacturing process is the same.

### EFFICIENT LOGISTICS

Stock holding of the profiles uses a smaller footprint.

The finished products can also be delivered in knock down form.



### DESIGNED FOR INSTALLERS

Engineered to streamline installation, and long-term service, reduced labor time, minimizing call-backs, and improving overall profitability for your manufacturing and dealer network.



# THE RHINOTRUSION

## MINIMALIST & SLEEK DESIGN FOR PERFECTLY MATCHED PRODUCTS

SIGHTLINES

Our systems are engineered with a clear design philosophy—clean lines, modern proportions, and minimal visual interruption.

Consistent profile geometry ensures every product maintains a refined, contemporary appearance across the entire range.

For manufacturers, this uniform approach allows aluminum, wood, or hybrid material combinations to be integrated seamlessly.

The result is a flexible platform that supports multiple material options while delivering a consistent, high-end architectural aesthetic.

- Consistent Aesthetic: Clean lines and modern profiles ensure a uniform look across all materials.
- Seamless Integration: Engineered for smooth transitions, maintaining design integrity in any material combination.
- Material Flexibility: Choose from aluminum, wood, GlassIIEdge™ or hybrids without sacrificing visual harmony.
- High-End Appeal: A cohesive and sophisticated appearance regardless of structural or functional requirements.
- Versatile Application: Ideal for various architectural and fenestration needs while maintaining a sleek design.

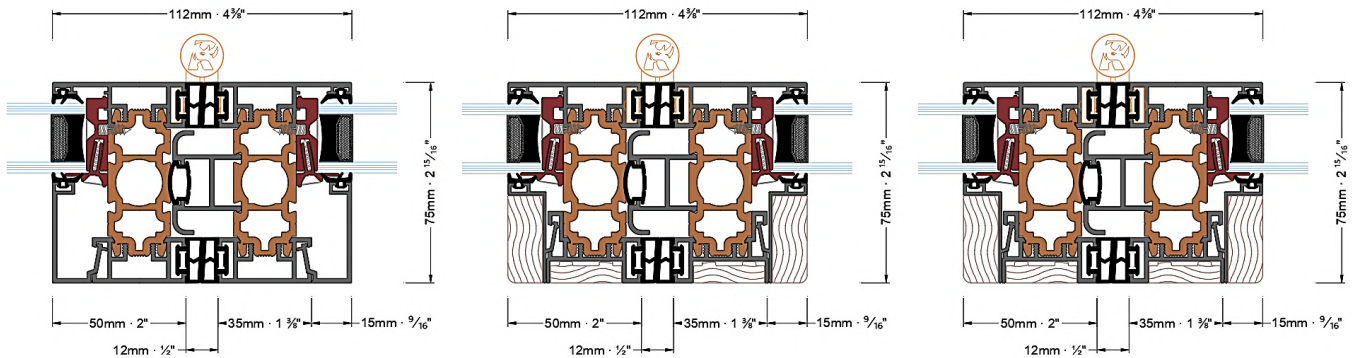

RT7550 AA  
Aluminum

RT7550 AW  
Aluminum & Wood

RT7550 WW  
Wood

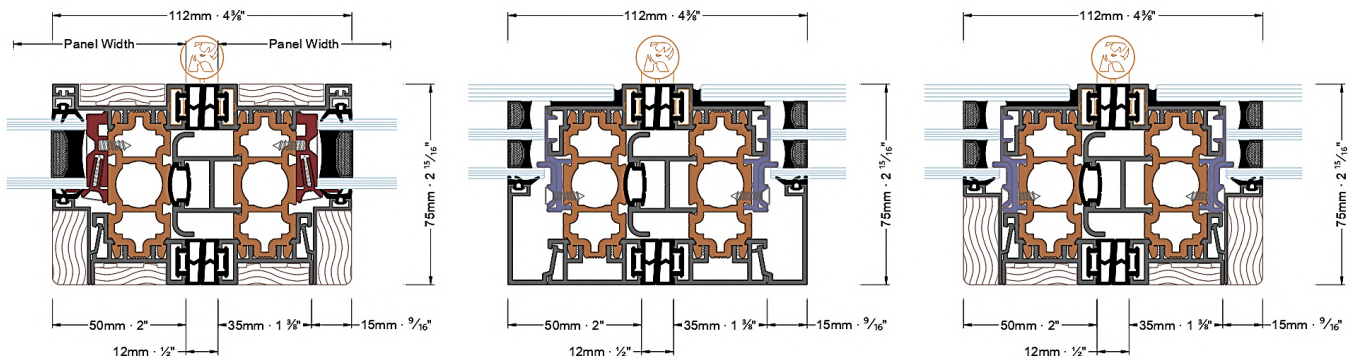

RT7550 CW  
Contemporary Wood

RT7550 AG  
Aluminum & GlassIIEdge

RT7550 AA  
Wood & GlassIIEdge

# FEATURES



GlassEdge™



THE RHINOTRUSION COLLECTION

10

REINVENTING THE WINDOW & DOOR INDUSTRY

## ENGINEERED SECURITY PERFORMANCE

Security is built into every Rhinotrusion system. Over the years, all of our designs undergo destructive testing in accredited laboratories, validating structural integrity and intrusion resistance under forced-entry and extreme load conditions.

Our systems are engineered to support advanced security hardware and configurations, including:

- Internally glazed units to prevent external bead removal
- High-security hinge systems for improved resistance to forced attack
- Interlocking door panels that restrict leverage at meeting stiles
- Anti-tamper locking hardware for added protection
- Multi-point locking compatibility for distributed frame engagement

The result is a robust platform that allows manufacturers to deliver high-security door and window systems without compromising design or performance.

SECURITY



# FEATURES



## WEATHER PERFORMANCE BUILT INTO THE SYSTEM

Our products are independently tested at accredited testing stations for extreme weather conditions. Most systems on the market are weather tight, with high performance rubber seals and brush seals. However, there are some systems that have little or no seals at all.

We use high performance rubber EPDM seals on every product. EPDM (ethylene propylene diene monomer (M-class) rubber) seals are fitted as standard and used to seal the glass units into the frame and where applicable the frames to each other, protecting the property from wind and water ingress.

**Exceptional Strength.** The fusion of our polymer matrix Winsul8 thermal break and aluminum imparts exceptional strength and durability.

For manufacturers, this translates into clear advantages:

- Proven weather performance through fully integrated EPDM sealing
- Stronger profiles with the Winsul8 composite core working with aluminum
- Thermally efficient systems that help meet modern building standards
- Reliable performance in demanding climates
- A premium system offering that strengthens product range



Rhinotrusion's Winsul8 Insulated Core System can be enhanced with integrated reinforcement, delivering increased structural strength while maintaining exceptional thermal performance.

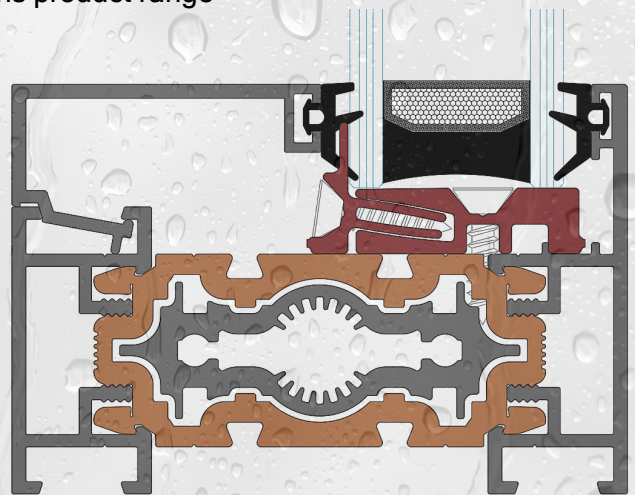

# FEATURES



Rhinotrusion Entrance Doors: Engineered Strength. Thermal Intelligence. Architectural Impact.

Rhinotrusion Entrance Doors provide manufacturers with a high-performance entrance system for residential and light commercial applications.

Built around our advanced composite core technology, the platform delivers exceptional structural strength, improved thermal performance, and modern architectural aesthetics.

The system supports solid, glazed, and Glass||Edge™ configurations with sidelights and over lights for maximum design flexibility.



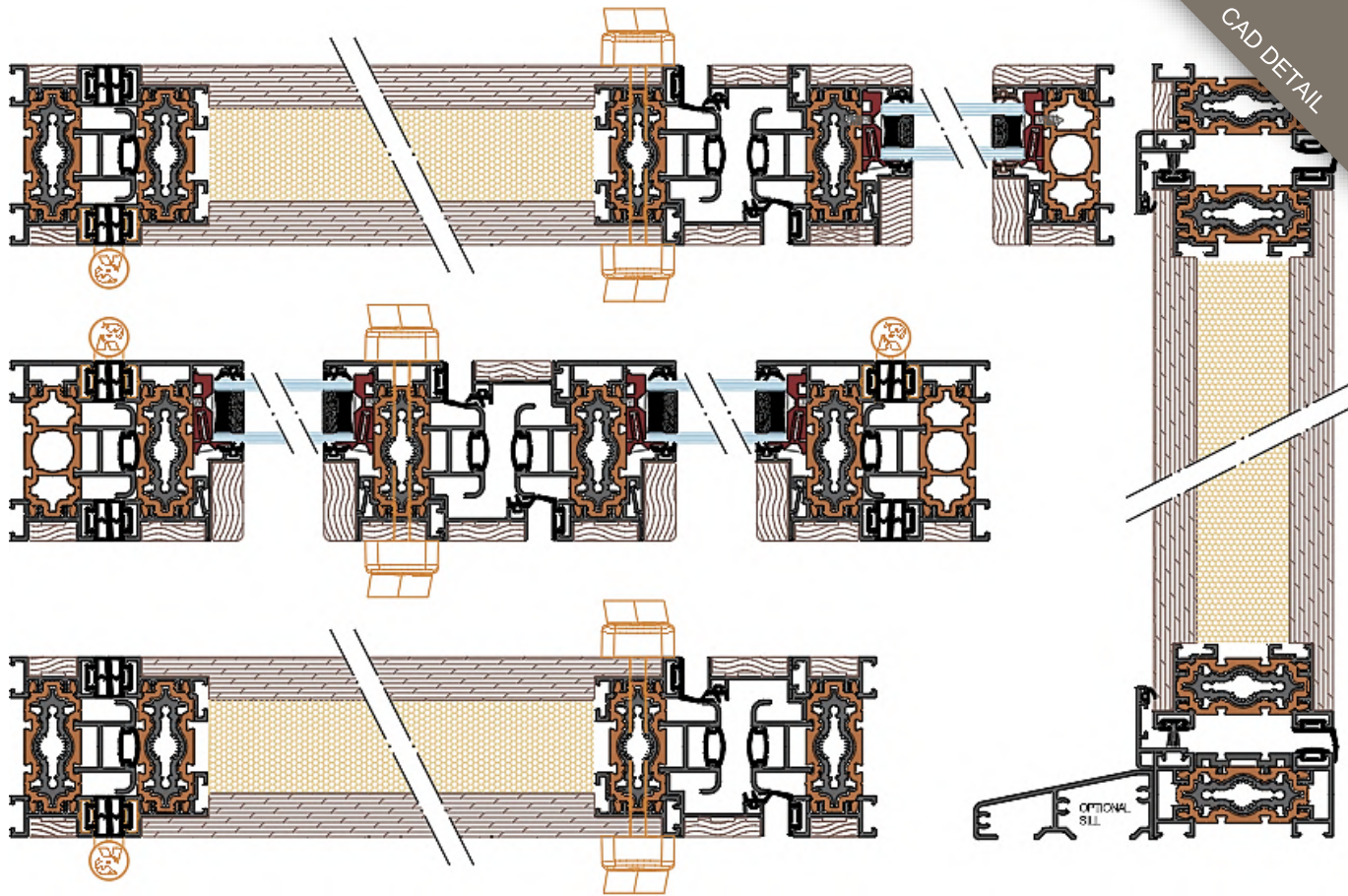

# ENTRANCE DOORS



## Rhinotrusion Pivot Doors: Architectural Scale. Engineered Performance.

Rhinotrusion Pivot Doors redefine the entrance statement. Designed for contemporary architecture and high-performance buildings, our pivot system combines structural integrity, thermal efficiency, and minimalist aesthetics in a single engineered platform.

### Engineered Around Performance

At the core of every Rhinotrusion pivot door is our advanced composite-insulated profile system. Unlike conventional aluminum-only doors, our technology integrates high-strength composite reinforcement with precision aluminum extrusions to deliver:

- Exceptional rigidity for oversized panels
- Superior thermal performance
- Reduced deflection under load
- Long-term dimensional stability

This allows architects and manufacturers to confidently specify large format entrance doors without compromising efficiency or durability.

### Precision Pivot Hardware Integration

Our pivot system is engineered to accommodate concealed, heavy-duty pivot mechanisms capable of supporting substantial door weights while maintaining smooth, balanced operation.



Key advantages include:

- Concealed top and bottom pivots
- Clean threshold detailing
- Optimized load transfer to substrate
- Minimal visual interruption

The result is a seamless door aesthetic with commercial-grade performance.

### Design Flexibility

Rhinotrusion Pivot Doors allow for a wide range of configurations:

- Oversized single pivot panels
- Sidelights and glazed inserts
- Flush-glazed Glass||Edge™ options
- Custom colors and anodized finishes
- Solid, glazed, or hybrid panel designs

Whether the project calls for ultra-minimal contemporary styling or bold architectural presence, our system adapts.

### Manufacturer-Focused Platform

For fabrication partners, Rhinotrusion delivers simplified production:

- Unified profile platform
- Reduced SKU complexity
- Engineered tolerance control
- Scalable for low or high-volume manufacturing

Our RhinoCrash Network partners benefit from structured support, technical documentation, and system integration guidance.



# ENTRANCE DOORS

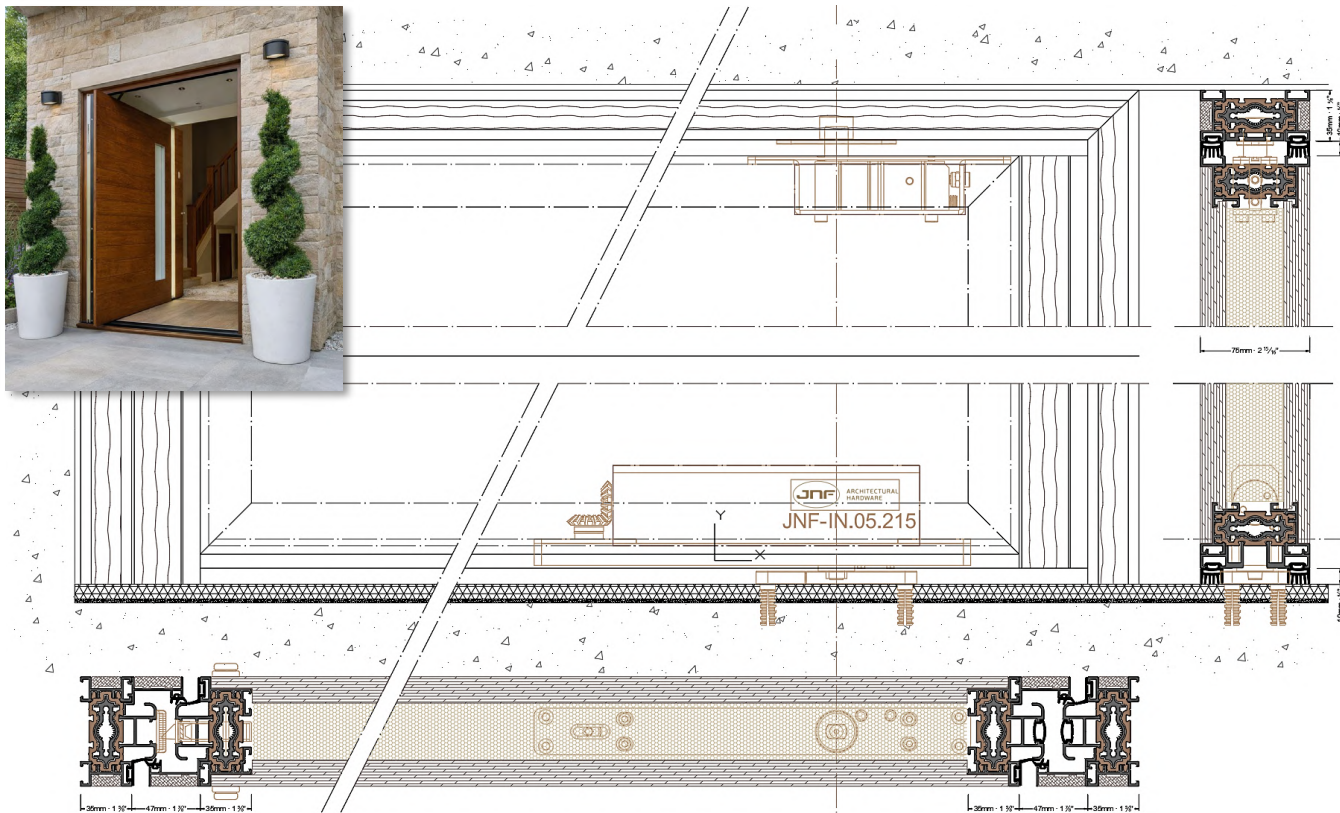
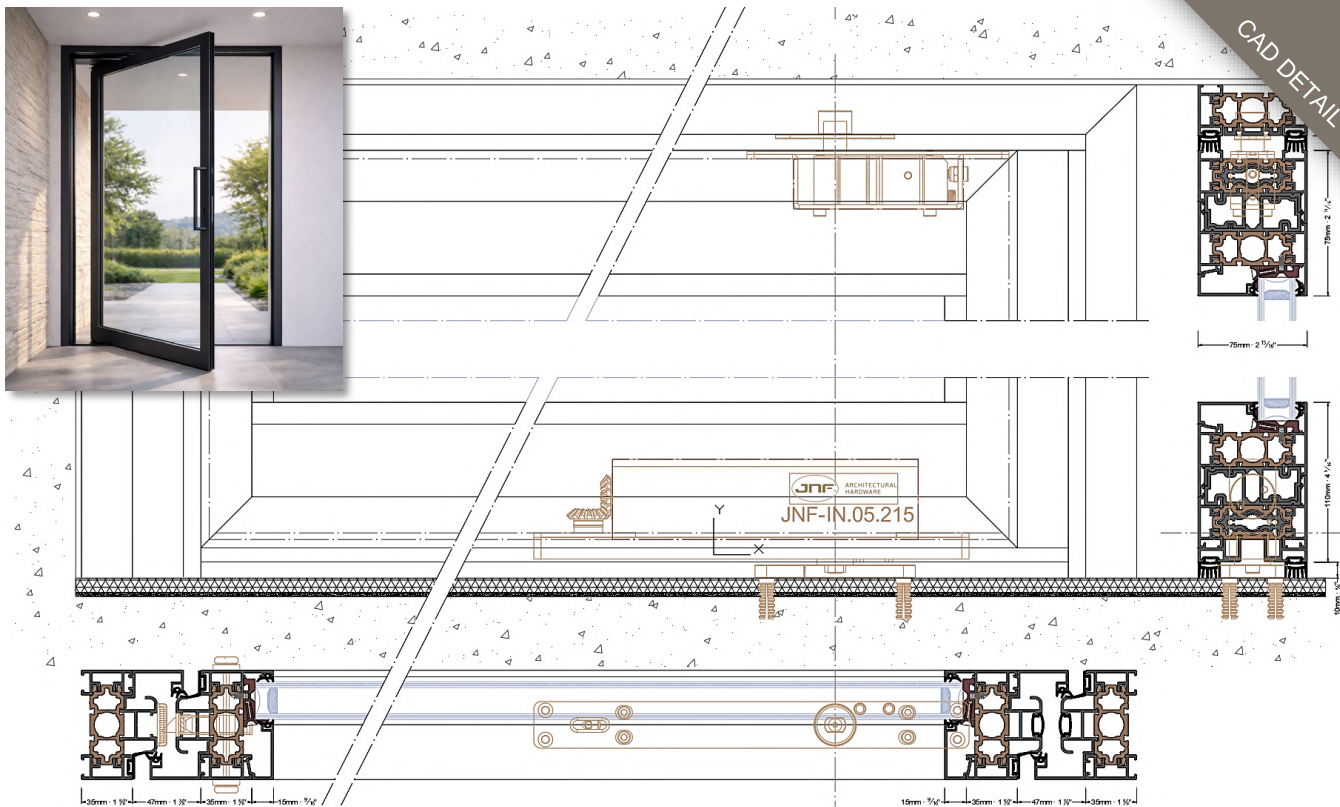

# ENTRANCE DOORS

# APPLICATIONS; RESIDENTIAL, COMMERCIAL & PUBLIC BUILDINGS

There are so many situations in which Rhinotrusion products can be the perfect solution to improving a living / working space and the environment.

Stacking door systems break down barriers by creating wider openings with a vast range of applicational uses from domestic to huge commercial installations.



RESTAURANTS



PUBLIC BUILDINGS



STORE FRONTS



FAST FOOD



GARDEN OFFICE



SERVERIES



BALCONIES



VACATION HOMES



GAMES ROOM



PATIOS



COURT YARDS



SUMMER ROOMS



SCHOOLS



FOOD TRUCK



CABINS



KINDERGARTEN



NEW BUILDS



CAFÉS



HOUSEBOATS



STADIUMS



RESTAURANT/BARS

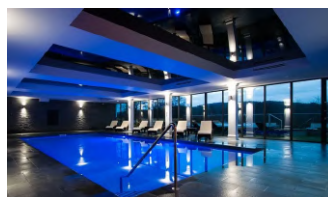

SWIMMING POOLS



CAR SHOWROOMS

# STACKING DOORS



**FOLDING SLIDING**

Panels hinge together and stack neatly to one or both sides of the opening.



**CENTER FOLD**

Center fold or center-hung panels are suspended from an overhead track and fold central to the opening, creating a clean, symmetrical reveal.



**INDEPENDENT STACKING**

Each panel operates independently and stacks to one or multiple parking positions. Ideal for restaurants, retail, and adaptable spaces requiring partial or staged openings. This can also be used for single track sliding doors.

# STACKING DOORS



### CORNER SYSTEMS

Corner door consist of two or more sets of stacking or sliding doors (or both) that elegantly meet at a corner point, providing flexibility for both 90° internal and external corners. A fixed 45° to 90° adjustable corner post is also available.



### CURVED & SEGMENTED SYSTEMS

Curved configurations create fluid sightlines and striking visual impact. They can be engineered across our single-track sliding, stacking, frameless, and framed systems, Tracks can be segmented or a true curve. No bottom track required.



### MAXIMUM GLASS SYSTEMS

Frameless or framed sliding glass systems that deliver maximum transparency with clean, minimal sightlines; while protecting against cold, heat, wind, rain, and noise. This can also be used for single track sliding doors.

# STACKING DOORS



HORIZONTAL SLIDING

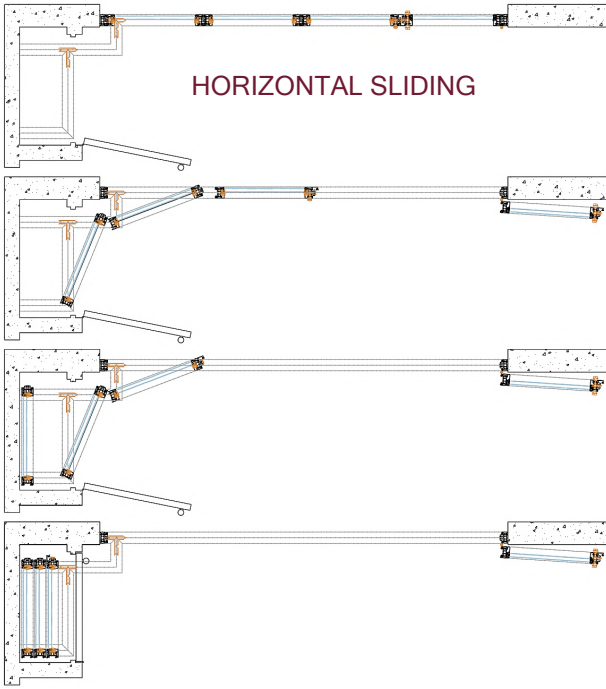

INDEPENDENT

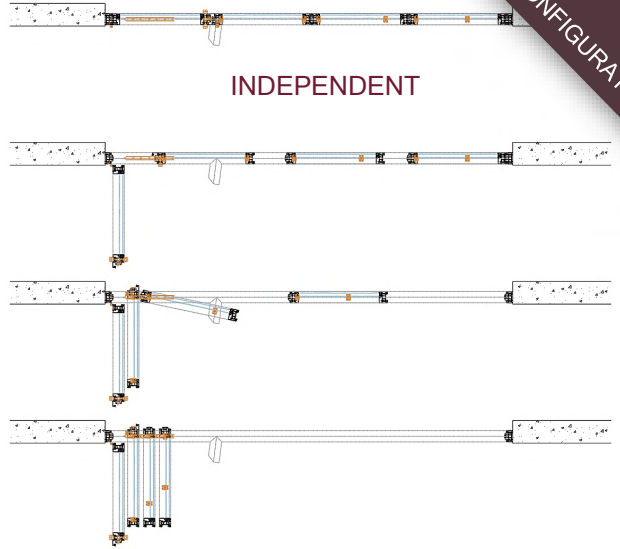

FOLDING SLIDING

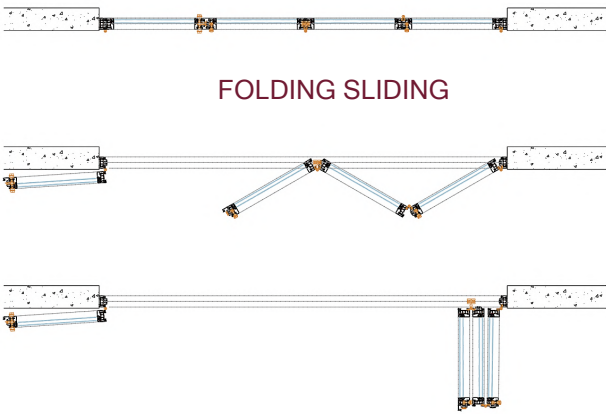

FOLD AROUND

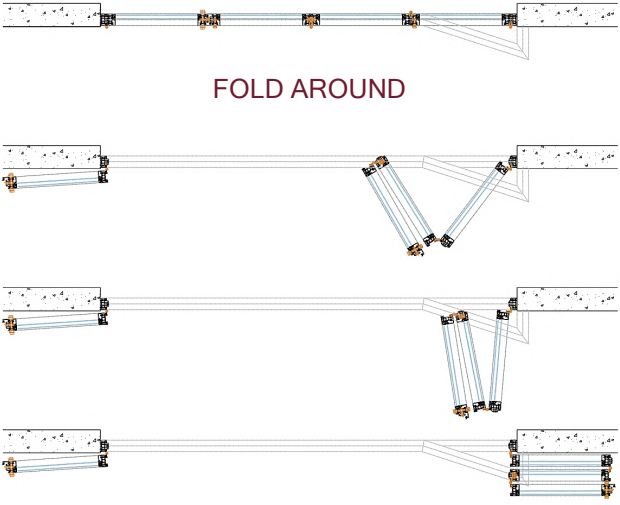

CENTER HUNG

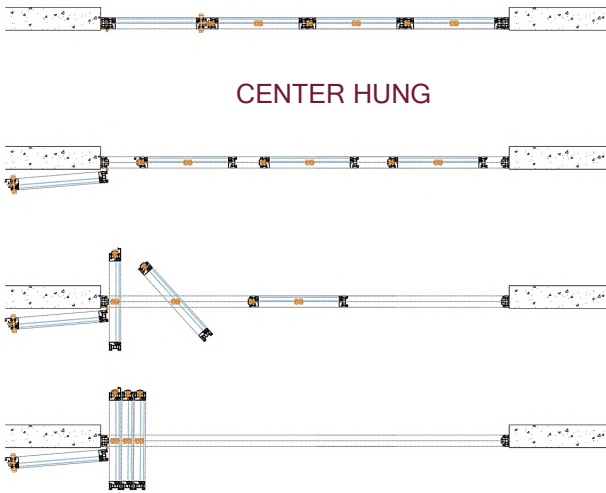

CENTER FOLD

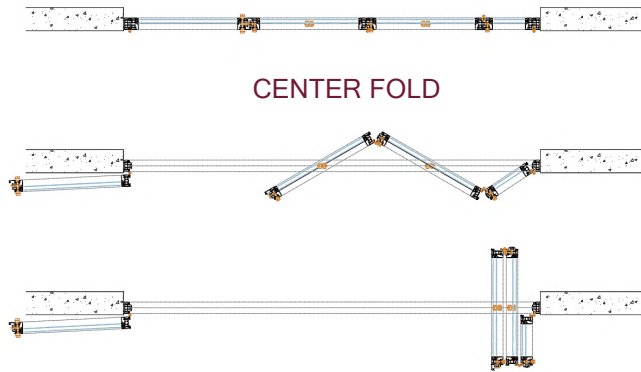

CURVED



# STACKING DOORS

## CREATING WIDER OPENINGS WITH FOLDING DOORS

Rhinotrusion folding door and window systems are engineered to help manufacturers deliver large openings with over 90% clear access, while avoiding the complexity of multiple tracks or recessed floor systems.

The platform is designed for smooth operation, structural reliability, and clean architectural sightlines.

### Key Manufacturing Advantages

- Over 90% clear opening for maximum access and indoor-outdoor integration
- 100+ configuration options from simple 2-panel sets to large 10-panel systems
- Inward or outward opening with flexible stacking left, right, or center split
- Single-platform versatility for doors, pass-through windows, and corner sets
- Consistent system design across multiple applications and architectural styles



# STACKING DOORS

Independent

Center Fold

Center Hung

Bi-Folding  
Top Running

Bi-Folding  
Bottom Running

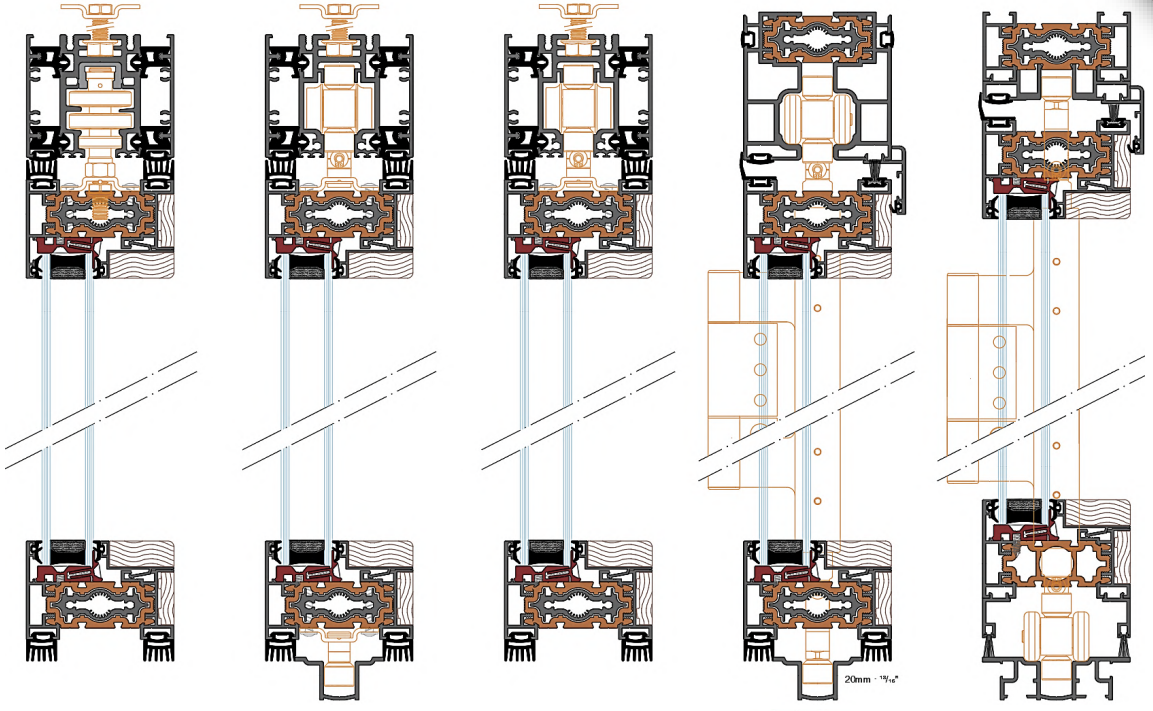

Independent

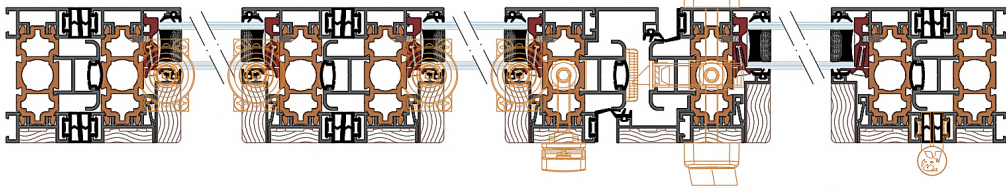

Center Hung

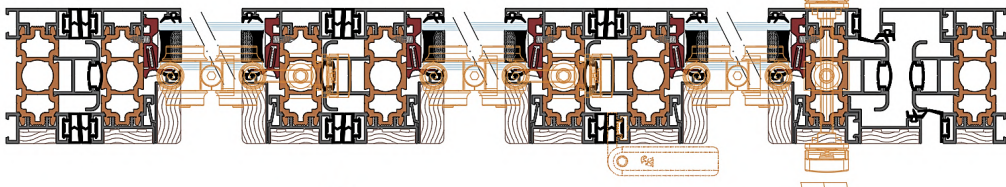

Center Fold

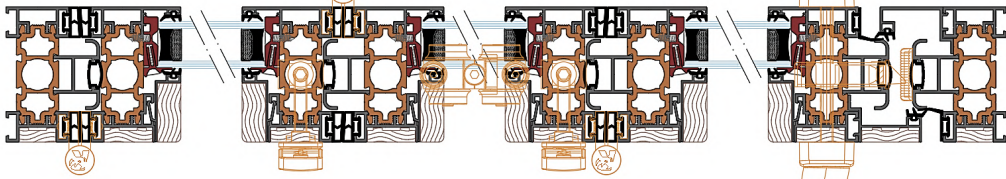

Bi-Folding

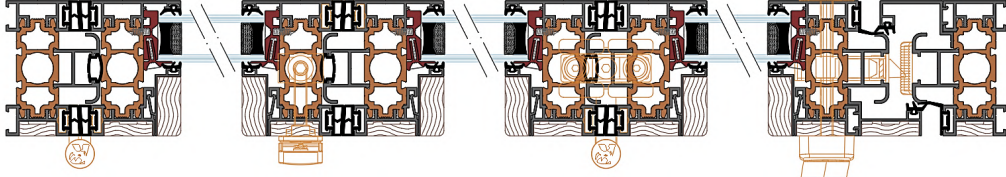

# STACKING DOORS

FLOATING OR FIXED CORNER SOLUTIONS

The system incorporates a corner post that moves with the doors, allowing a fully open glass corner without a structural column when used with a cantilevered roof. A 45° to 90° fixed corner post enables a precise angled corner in 5° increments.

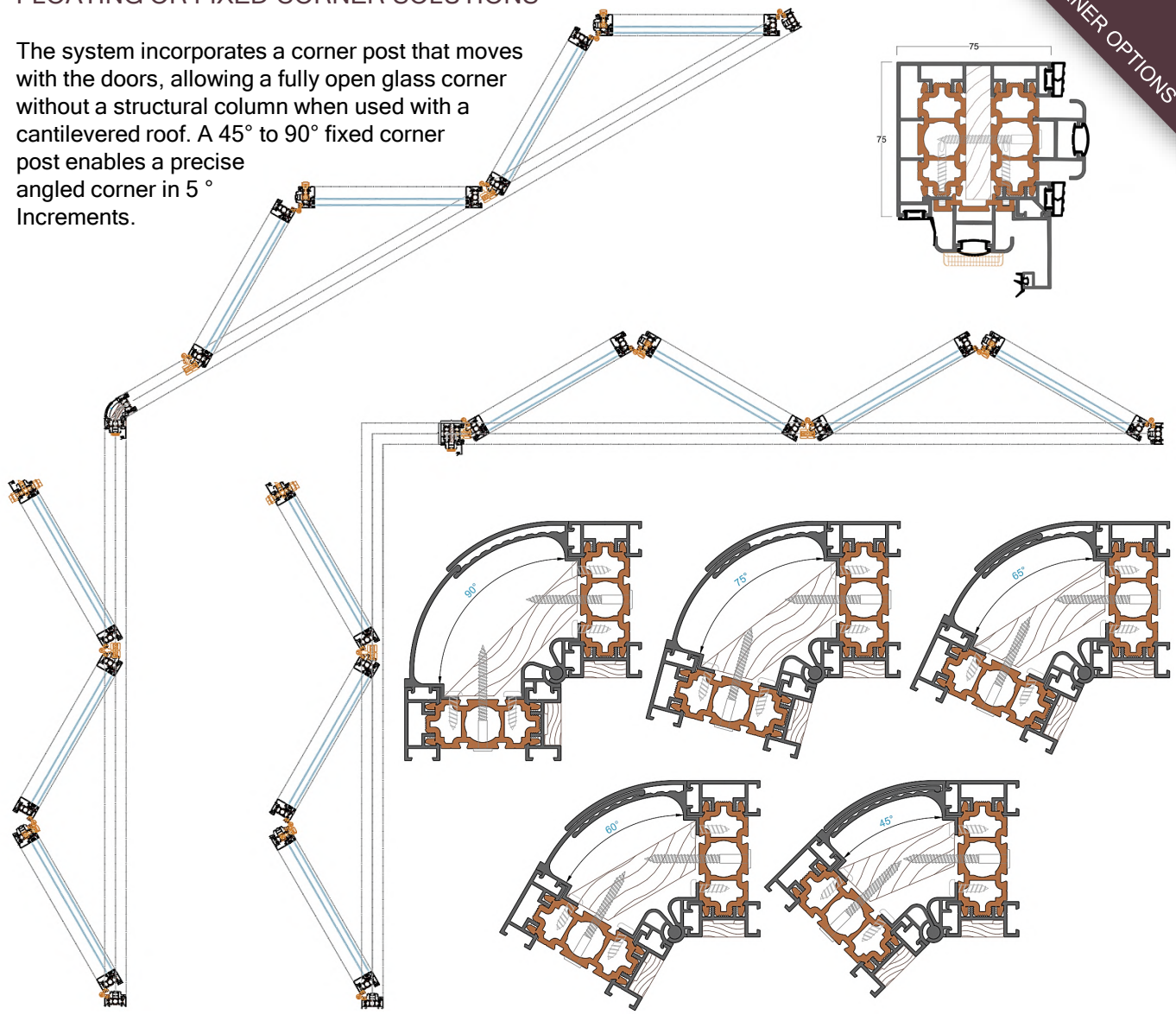

The Rhinotrusion corner systems incorporate an integrated 90° floating corner post that moves with the doors away from the corner point, enabling a fully open glass corner without the need for a structural column or brick pier when used with a cantilevered roof.

This configuration allows manufacturers to deliver dramatic open-corner installations that create a seamless indoor-outdoor transition and expansive living spaces.

In addition, the platform supports a fixed adjustable corner post configurable from 45° to 90°.

This provides manufacturers with greater architectural flexibility, enabling precise angled corner solutions while maintaining consistent sightlines, structural performance, and clean contemporary aesthetics across the system range.

# STACKING DOORS



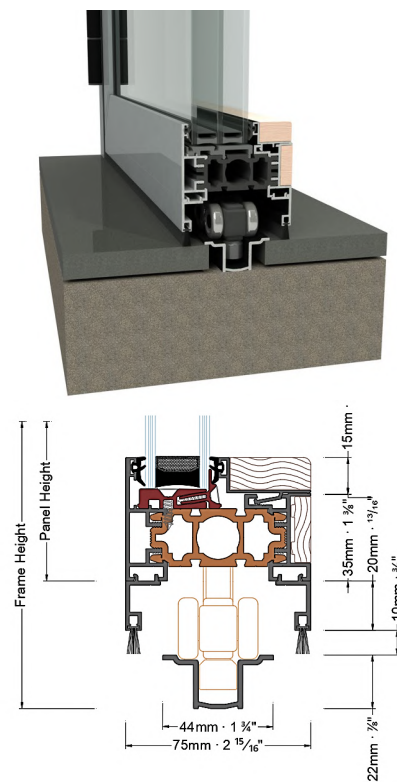
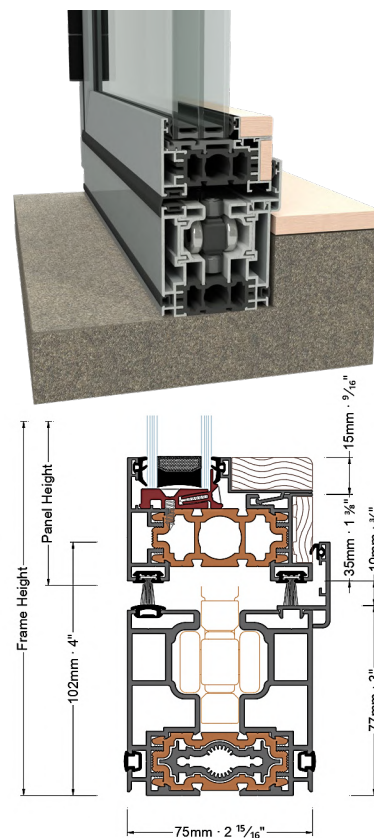
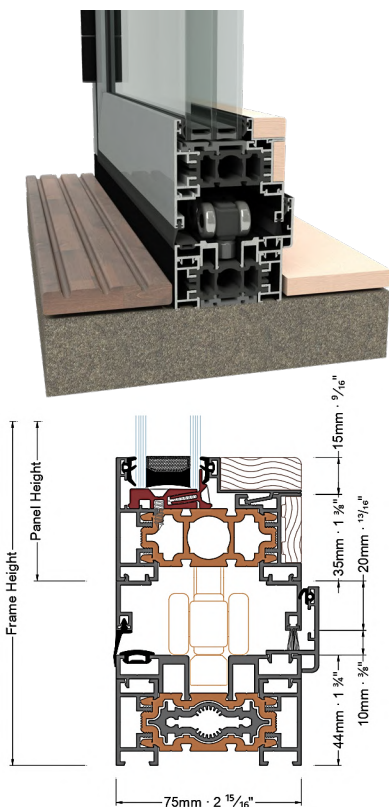
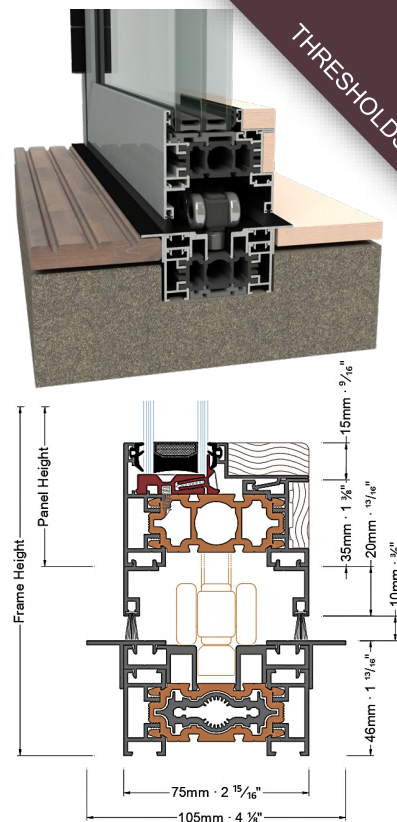
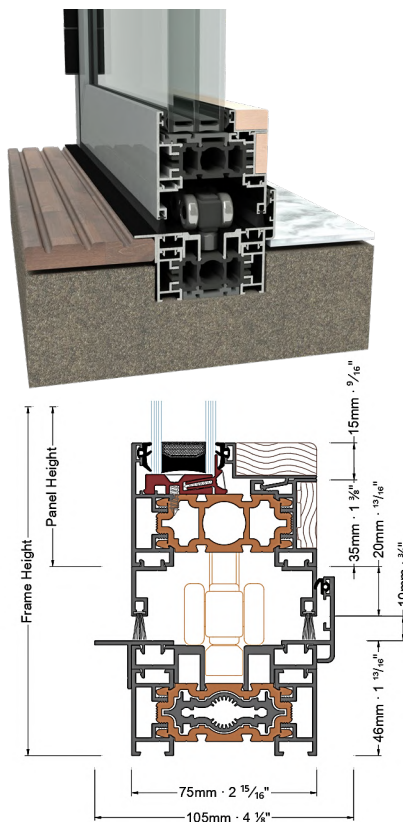
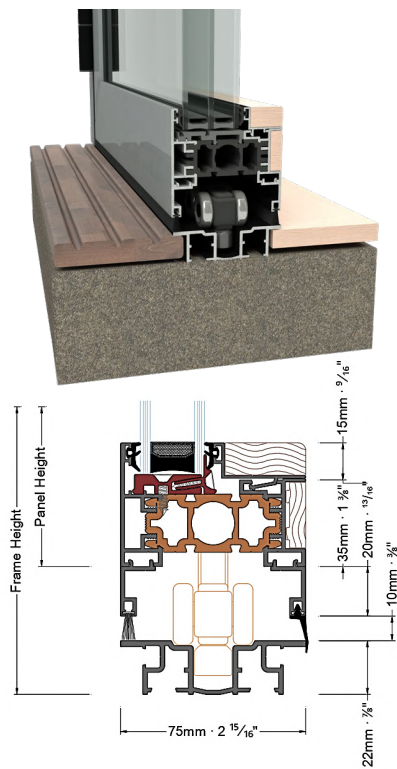

# STACKING DOORS

# MINIMAL FRAME GLAZING SOLUTIONS

FRAMELESS

## RT35F - Frameless Sliding Glazing System

The RT35F is a frameless sliding glass system designed to extend a manufacturer's product range with a clean, minimal aesthetic. It provides reliable protection from wind, rain, and external noise while maintaining maximum transparency. Panels slide fully open for ventilation and unobstructed views, or close to create a sheltered glazed space. A framed version is also available where additional weather performance is required.

## RT40F - Framed Insulated Sliding System

The RT40F is the framed version of the platform, engineered for higher weather performance and thermal efficiency. Designed to accommodate insulating glass units, it delivers improved wind resistance, watertightness, and insulation. Slim 40 mm (1 5/16") panel joints maintain excellent transparency and a clean architectural appearance.

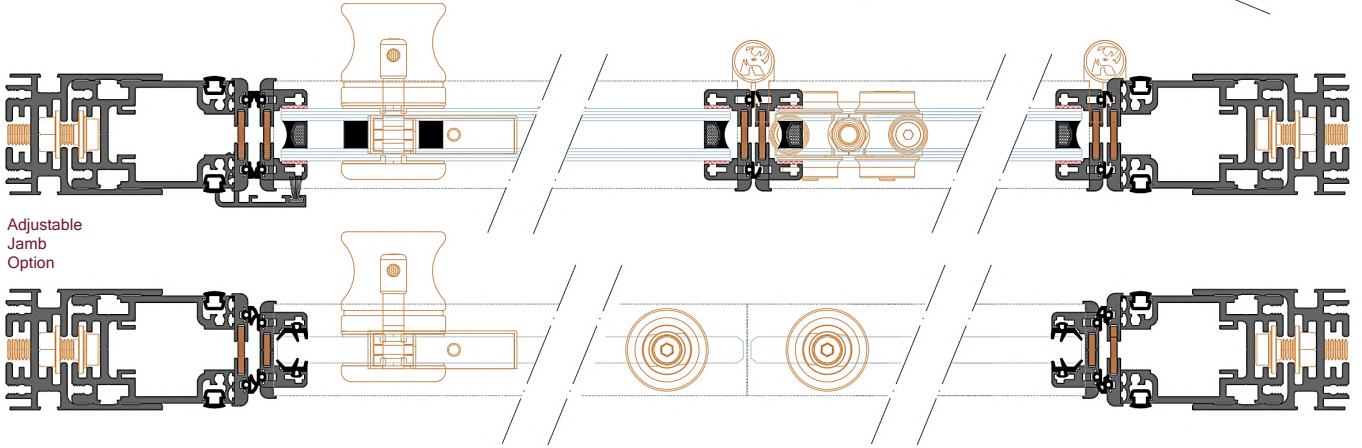
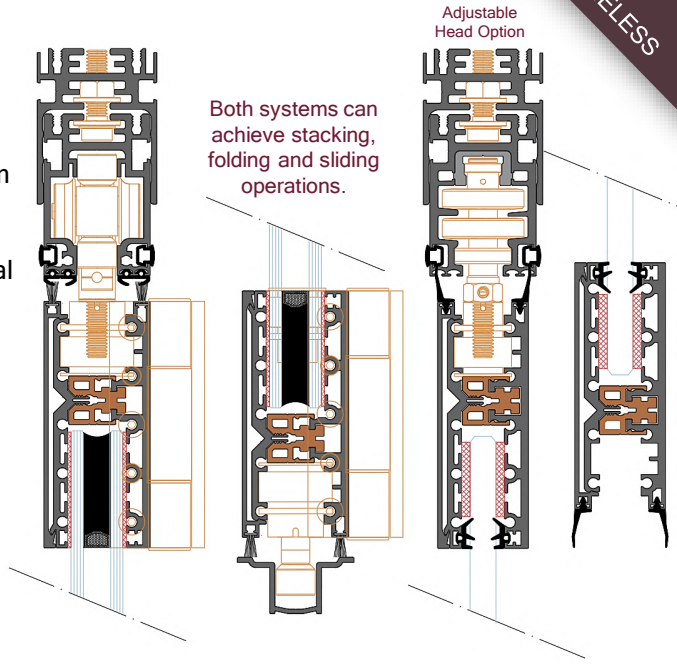

# STACKING DOORS



Bi-Folding

Independent

Center Fold

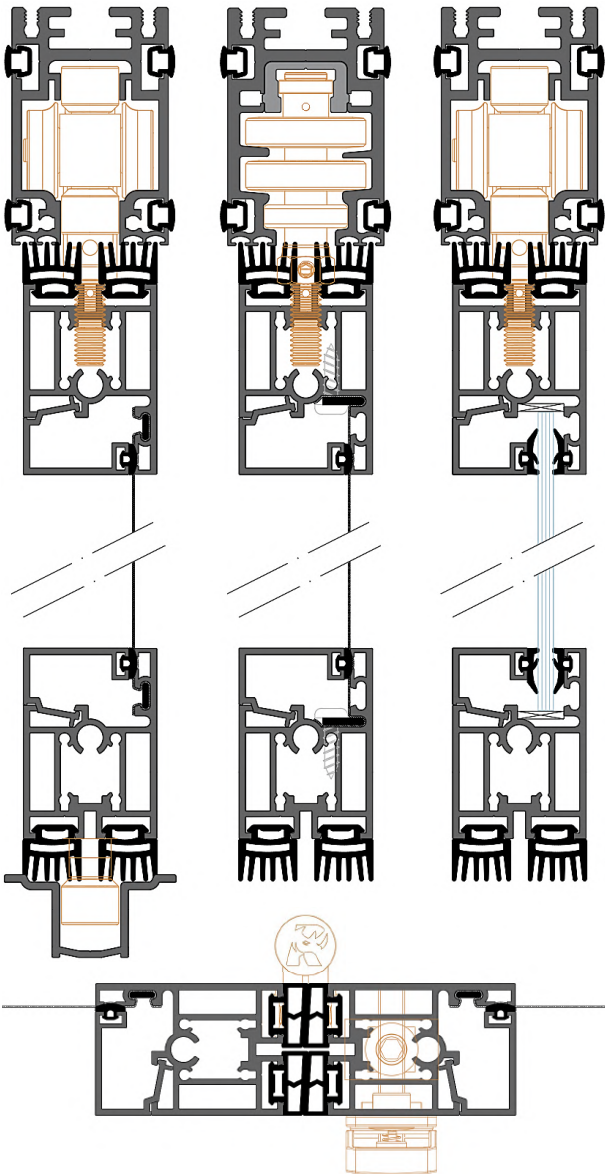

### Operable Security Screens

Rhinotrusion Operable Security Screen Doors are engineered to give manufacturers a straightforward, scalable solution for large openings. Designed to integrate seamlessly with existing product lines or operate as a stand-alone system, they deliver flexibility without disrupting your workflow.

- Simple fabrication process
- Consistent component strategy
- Efficient production

### Configuration Flexibility

- Side-hinged (swing) doors
- Bi-fold and center-folding systems
- Sliding configurations
- Multi-panel stacking systems

### Application Versatility

- Deck enclosures
- Large-span openings
- Patio and outdoor living spaces
- Retrofit applications to existing door systems
- Stand-alone security screen installations

This approach allows manufacturers to expand their offering into high-demand screening and security solutions.

The RT3550 system can also be glazed, allowing manufacturers to offer both security screen and glass door solutions using the same platform and fabrication method

# STACKING DOORS

## CRAFTED FOR YEAR-ROUND PERFORMANCE

Rhinotrusion Multi-Panel Sliding Doors are designed to give manufacturers a reliable platform for producing large architectural openings with smooth operation, clean sightlines, and efficient fabrication.

Architecturally, the system emphasizes minimal frame and maximum glass, creating bright, open spaces with expansive views and strong modern aesthetics.

For manufacturers, the platform is built for production efficiency and design flexibility. The system is available in a wide range of configurations and opening styles, including:

- Multi-panel sliding systems
- Pocket doors
- Corner opening doors
- Single-track stacking systems
- Large span panoramic openings

All sliding configurations are developed using the same manufacturing simplicity and fabrication methods used across all RT product systems, allowing manufacturers to integrate the platform easily into existing production workflows.



# STYLISH SLIDERS

### A SLIDING DOOR TO SUIT EVERY TASTE

Another great advantage with Rhinotrusion system is the track options available, with the quint track, an industry first!

Rhinotrusion offer a choice of; dual, triple, quad and quint tracks across all the multi sliding door systems, allowing for an unprecedented number of opening/sliding possibilities within the industry.

**Quint Track:** 5 to 10 panels - **Quad Track:** 4 to 8 panels - **Triple Track:** 3 to 6 panels - **Dual Track:** 2 to 4 panels

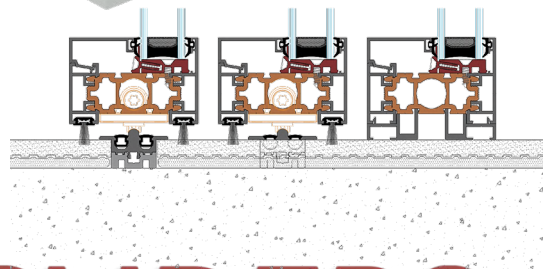
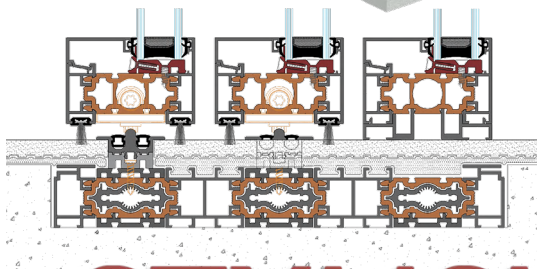
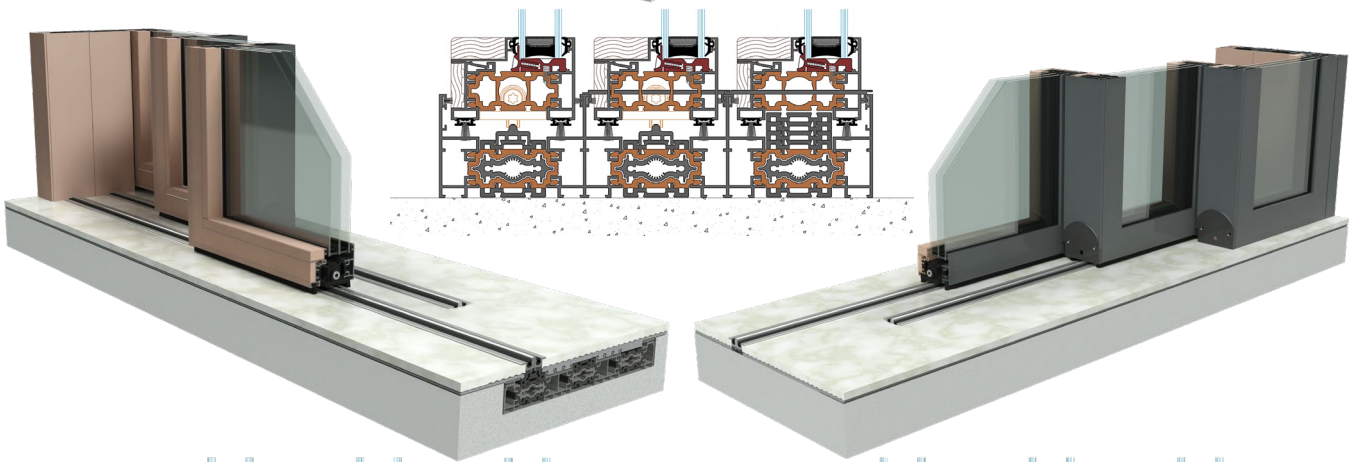
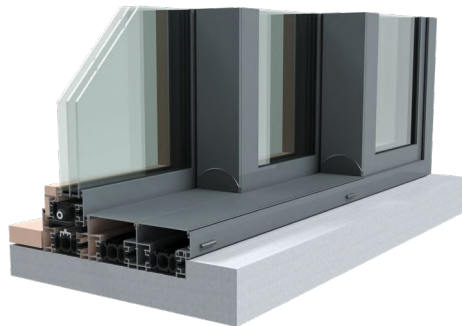

# STYLISH SLIDERS



## TWIN TRACK SLIDERS

Two- and four-panel twin track systems offer a practical, clean solution with up to 50% clear opening. Designed for easy fabrication and smooth operation, they support spans over 5000 mm / 197" and heights up to 3000 mm / 118", using minimal panel divisions.

## TRIPLE TRACK SLIDERS

Triple track systems provide flexible configurations, including sliding and fixed panel options. Three-panel setups achieve up to two-thirds opening, while larger six-panel layouts increase opening size. Suitable for spans beyond 7500 mm / 295" and heights up to 3000 mm / 118".



## QUADRUPLE TRACK SLIDERS

Four-track systems allow panels to stack to one side, delivering up to 75% clear opening. Designed for wide spans over 10,000 mm / 394" and heights up to 3000 mm / 118", ideal for large openings with consistent performance.

## QUINTUPLE TRACK SLIDERS

Five-track systems maximize opening size, with panels stacking to one side for up to 80% clear opening. Suitable for spans exceeding 12,500 mm / 492" and heights up to 3000 mm / 118", offering smooth operation on large-scale projects.



## LIFT AND SLIDE DOORS

The Rhinotrusion LS builds on the RT7550 platform, maintaining the same slim frame and clean sightlines while integrating a lift-and-slide mechanism for smoother operation. Panels can be locked in any position for added flexibility, with improved weather performance ensuring reliable use across all conditions.

# STYLISH SLIDERS

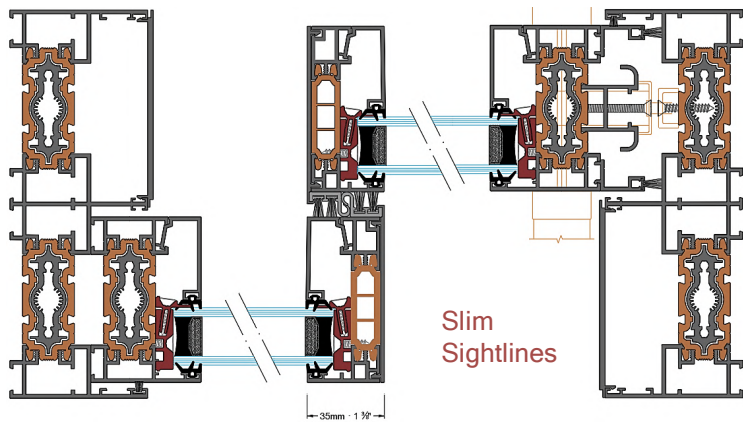

Slim Sightlines

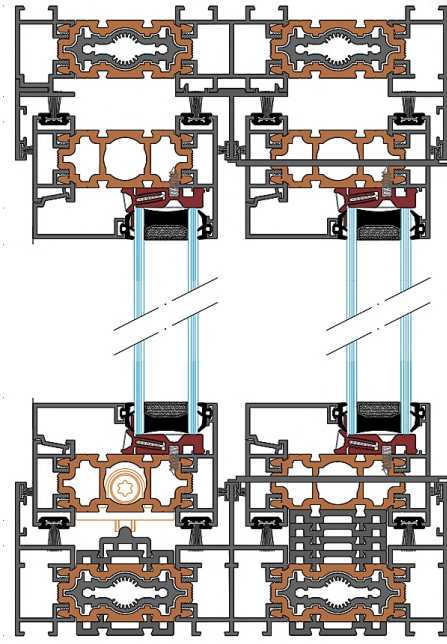

Slender Sightlines

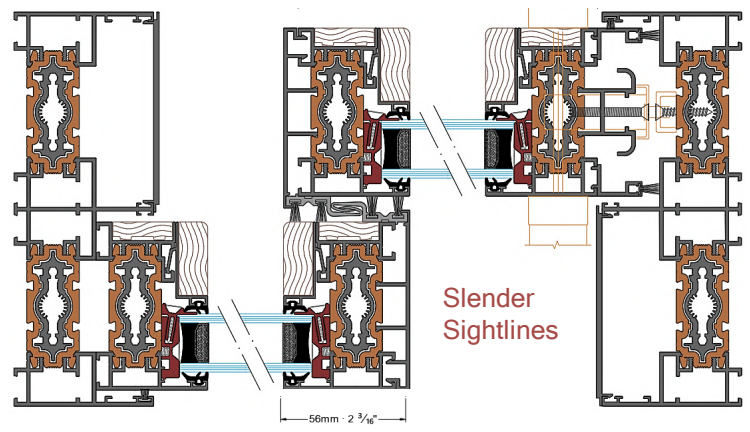
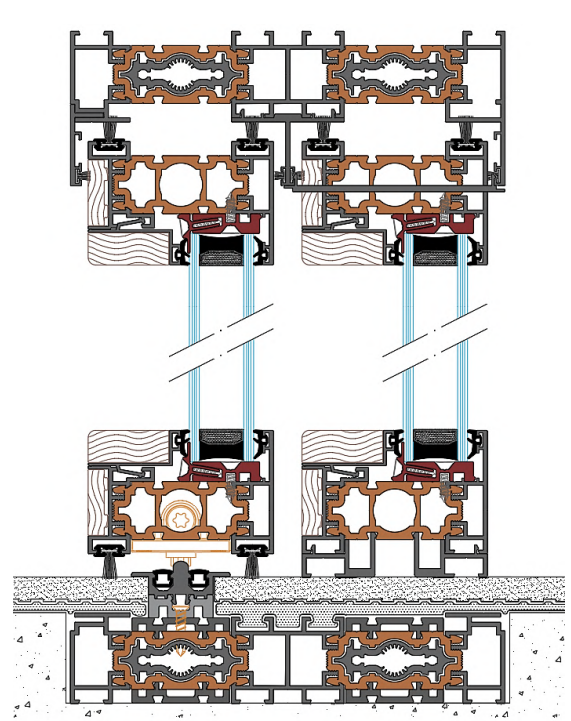

# STYLISH SLIDERS

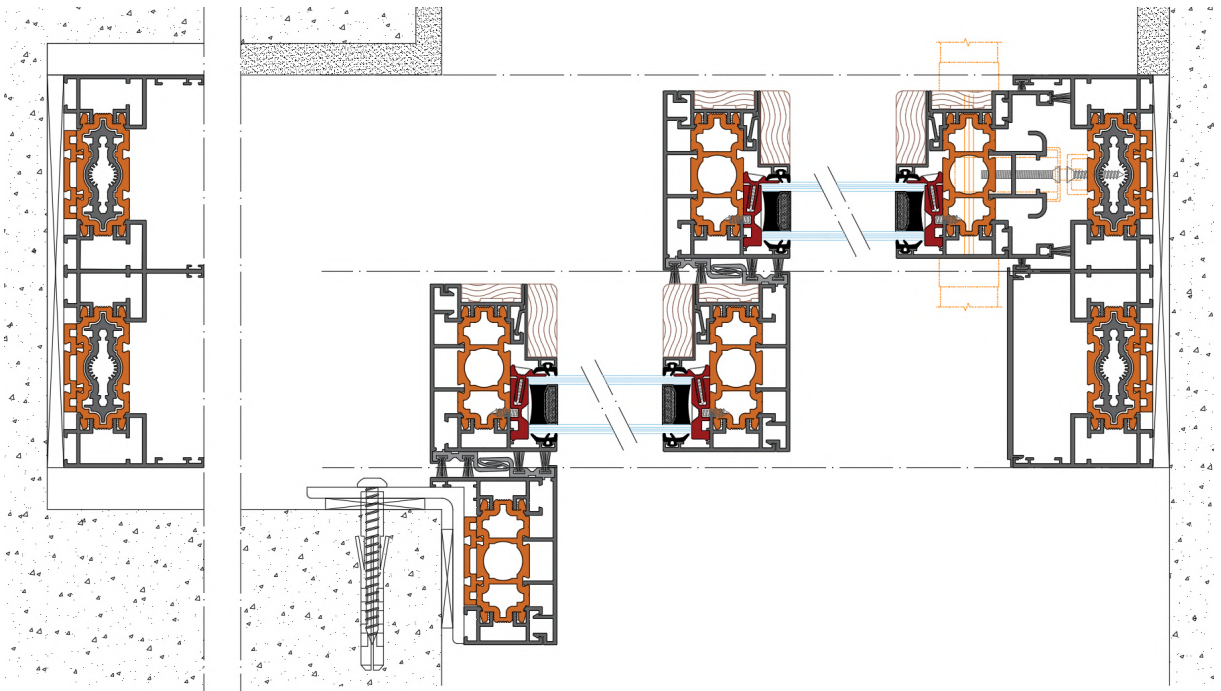

## RHINOTRUSION'S POCKET DOOR SYSTEM

Rhinotrusion Pocket Doors enable manufacturers to deliver true full-aperture openings, with panels that glide completely into concealed cavities for a clean, uninterrupted finish. Engineered on the same core platform as our sliding systems, pocket configurations maintain identical profiles, hardware integration, and fabrication simplicity—minimizing additional complexity on the factory floor.

Designed for integration into modern construction methods, Rhinotrusion Pocket Doors provide a high-value upgrade to standard sliding systems—offering enhanced architectural appeal, maximum opening widths, and seamless indoor-outdoor transitions without changing your production workflow.

# STYLISH SLIDERS

SINGLE TRACK

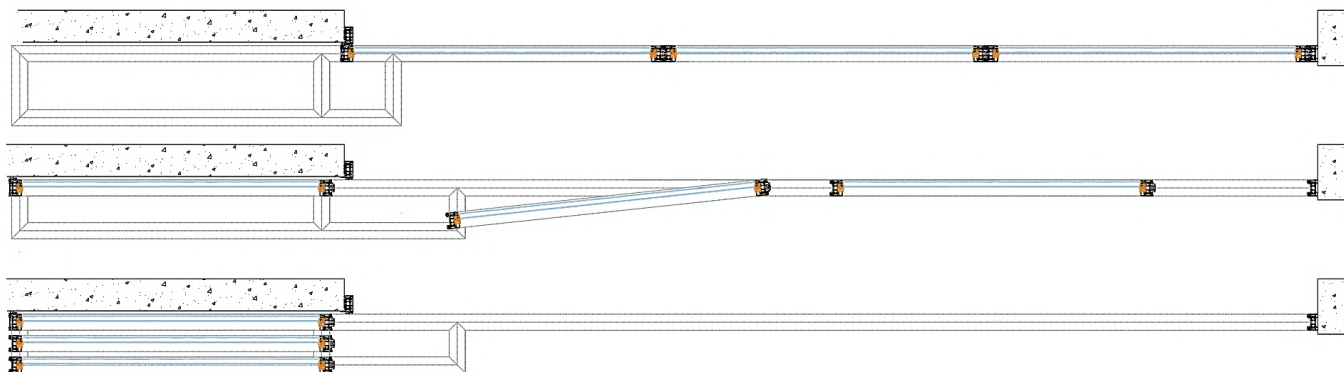
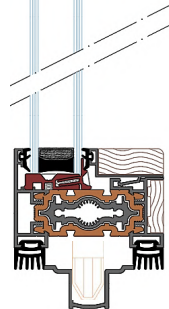
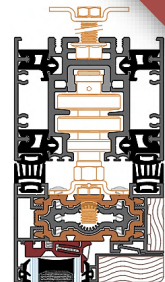
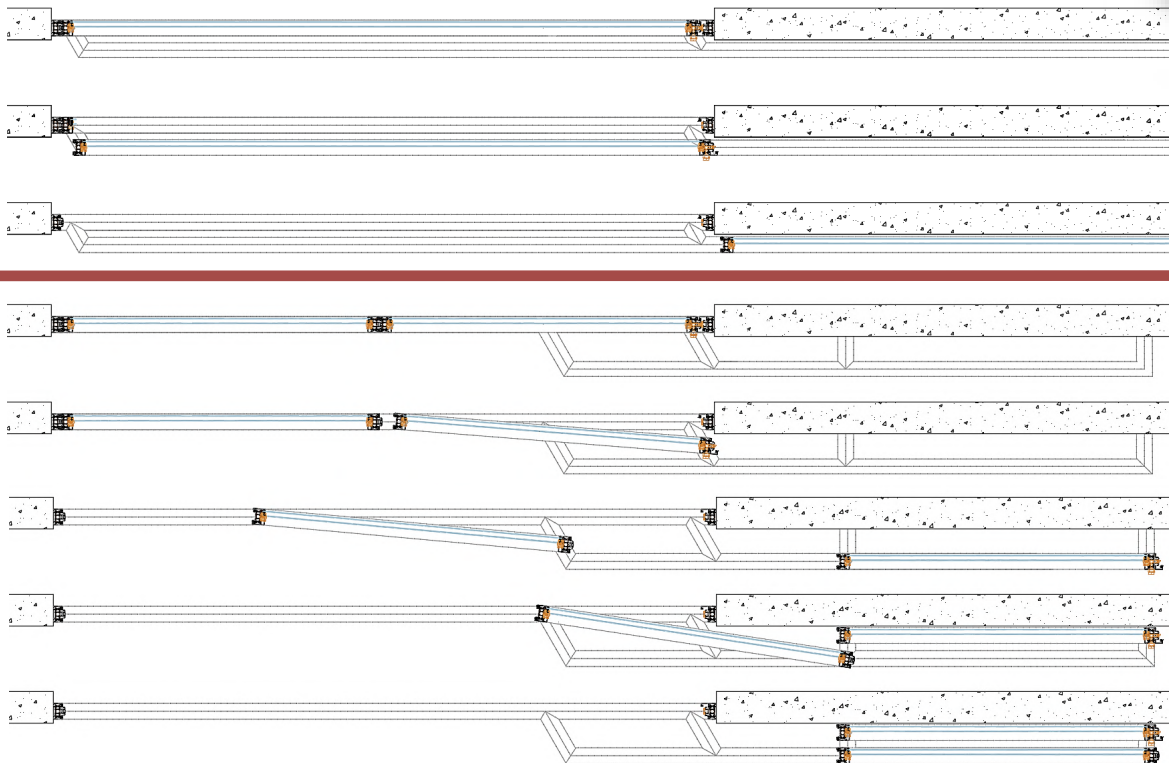

# STYLISH SLIDERS

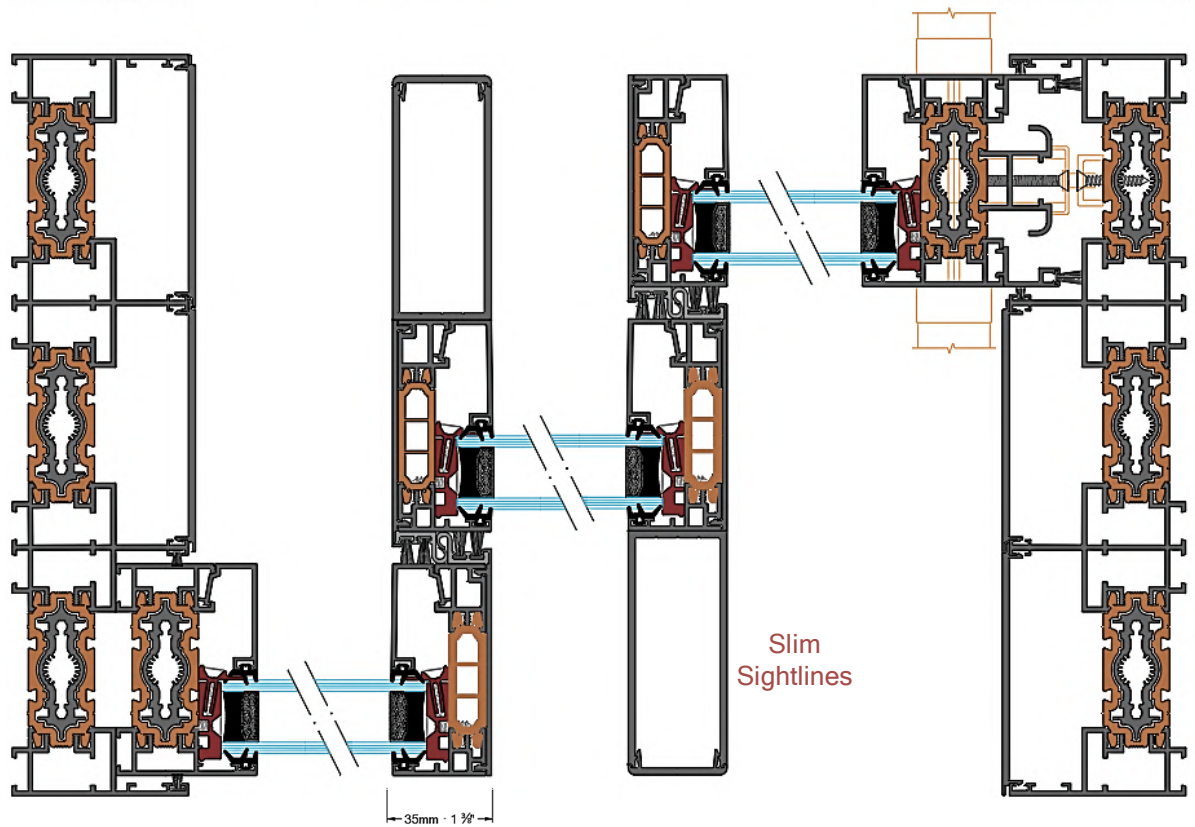
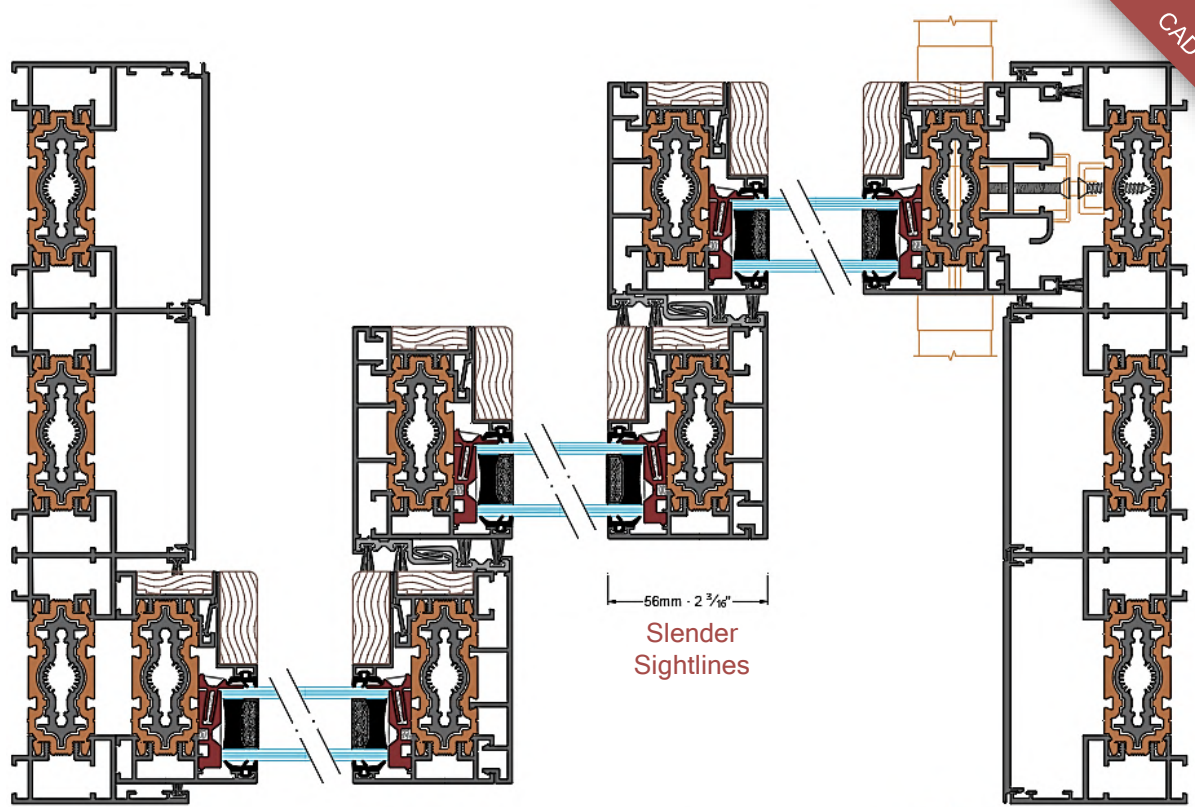

# STYLISH SLIDERS

## A BETTER OUTLOOK

BI-FOLDING

Rhinotrusion Bi-fold Windows are a direct extension of your bi-fold door systems, using the same profiles, hardware, and fabrication methods. This allows you to offer a high-impact product without adding complexity to production.

- Manufacturing Benefits - Same system, same process – no new tooling or training
- Easy to fabricate using existing door system knowledge
- Flexible sizing and configurations. Matching existing door aesthetics
- Applications - Pass-through / bar-top windows. Kitchens and patios. Hospitality and outdoor spaces







## FLUSH CASEMENT WINDOWS

Flush casement windows have become increasingly popular in the door and window industry due to their seamless combination of modern aesthetics, durable performance, and minimal upkeep needs. Offering a sleek design, with sashes that sit flush against the frame when closed, creating a clean and sophisticated look.

Our Aluminum flush casement windows are flush inside and out, offering strength, security, durability and are virtually maintenance free. Winsul8 thermally insulated profiles provide an energy efficient product that offer an 'A-rated' energy efficiency.

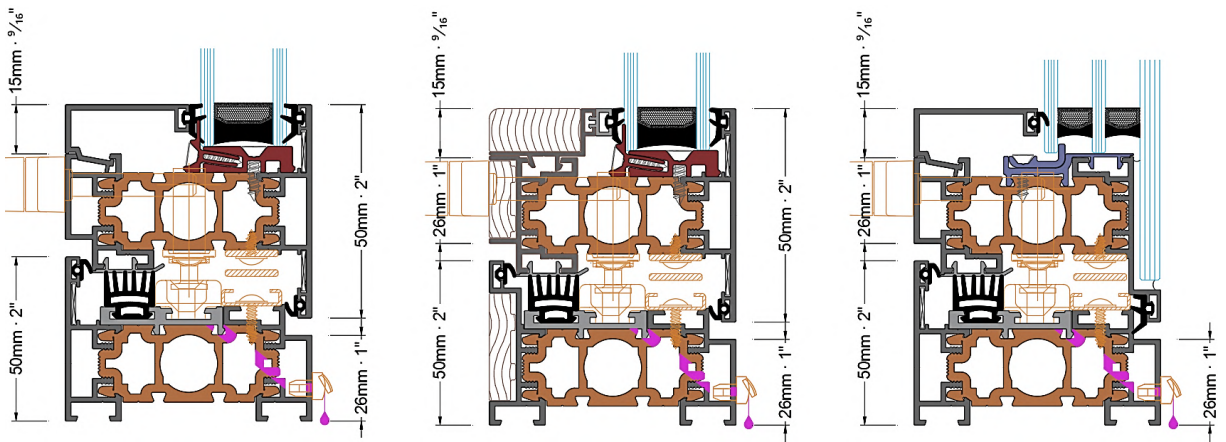

# WINDOWS



## PICTURE WINDOWS – CLEAN, SCALABLE FIXED GLAZING

Rhinotrusion Picture Windows give manufacturers a simple, high-margin fixed glazing option using the same system approach as our operable products. Designed for large, uninterrupted glass areas, they deliver strong visual impact with minimal fabrication complexity.

### MANUFACTURING BENEFITS

- Fixed system – no moving parts, simplified assembly
- Same profiles and methods – aligned with existing Rhinotrusion systems
- Efficient production – reduced hardware, faster throughput
- Consistent sightlines – integrates with your full product range

### PERFORMANCE & FLEXIBILITY

- Supports large glass sizes for maximum light and visibility
- Compatible with modern glazing options for thermal performance
- Can be combined with operable units (casement, sliding, bi-fold)

### APPLICATIONS

- Living spaces and feature openings
- Residential and light commercial projects
- Anywhere large, unobstructed views are required

A straightforward addition that delivers strong architectural value with minimal impact on manufacturing.



# WINDOWS



**Rhinotrusion Movable Walls: Engineered Flexibility. Commercial Durability.**

Engineered with the same manufacturing simplicity and fabrication methods used across all of our systems. Rhinotrusion Movable Walls provide manufacturers with a robust platform for producing flexible partition systems that transform open-plan environments into adaptable spaces. The system delivers strong structural performance, effective acoustic separation, and durability, smooth operation, and refined aesthetics while maintaining efficient fabrication and installation.

**Bifold System**

Compact and efficient. Panels fold neatly to one side, minimizing stacking footprint while enabling rapid space reconfiguration. Ideal for educational, corporate, and hospitality environments requiring frequent transitions.

**Center Fold System**

Balanced and symmetrical. Panels split and stack to both sides of the opening, reducing individual stack depth and distributing load evenly across the head track system.

**Independent Panel Stacking (Floating)**

Maximum flexibility. Each panel operates independently, allowing custom stacking arrangements at remote storage bays. Perfect for large spans, premium commercial interiors, and projects requiring refined architectural detailing.

**Engineered Performance**

- High Structural Rigidity - Reinforced aluminum framing.
- Acoustic Control - Engineered core enhance sound attenuation.
- Smooth Overhead Track Operation
- Minimal Floor Interruption
- Integrated Access Doors - Optional pass doors seamlessly integrated into panel assemblies.

**Designed for Modern Environments**

- Schools & Universities
- Conference & Event Spaces
- Hospitality & Restaurants
- Corporate Offices
- Community & Civic Buildings

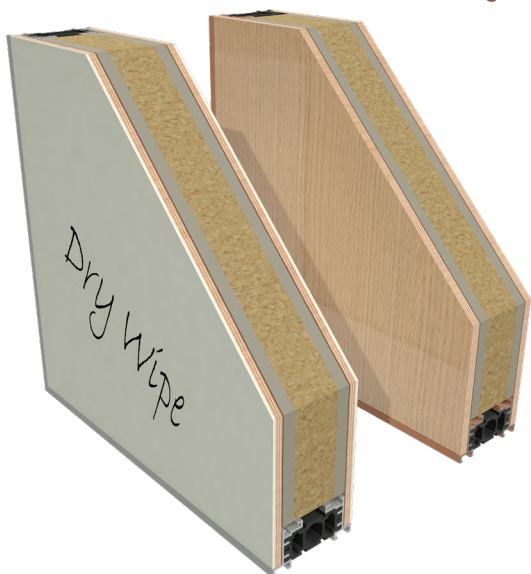

# MOVABLE WALLS

Independent

Center Fold

Center Hung

Bi-Folding  
Top Running

Bi-Folding  
Bottom Running

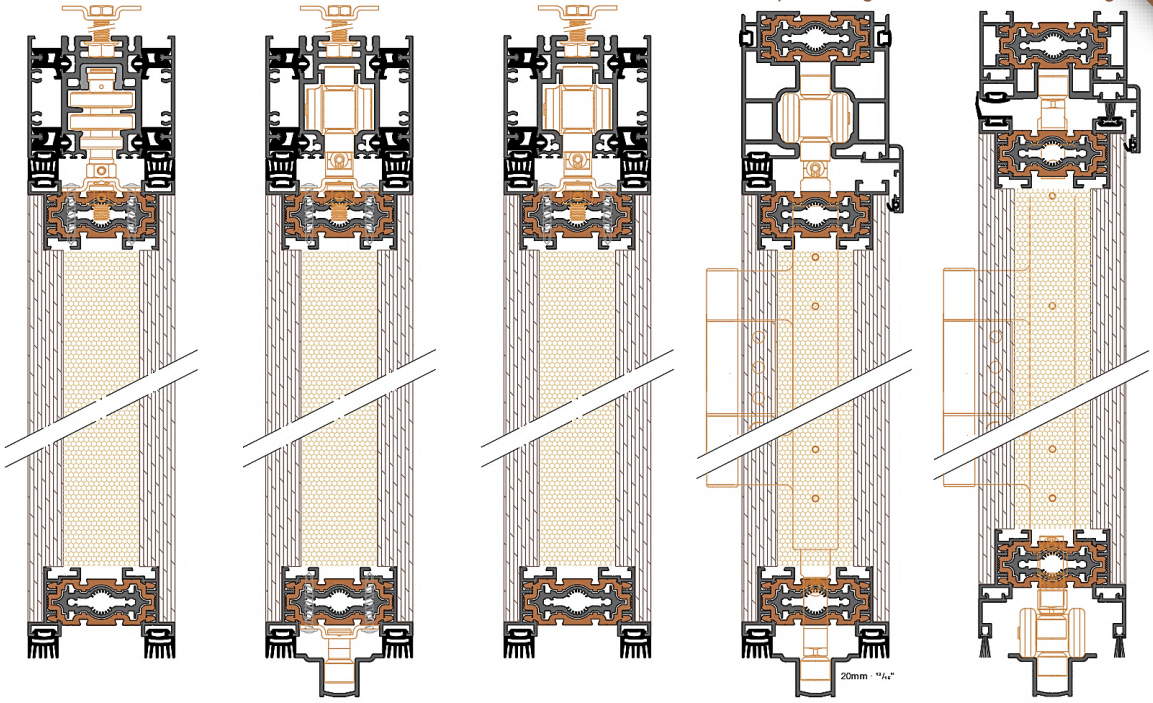

Independent

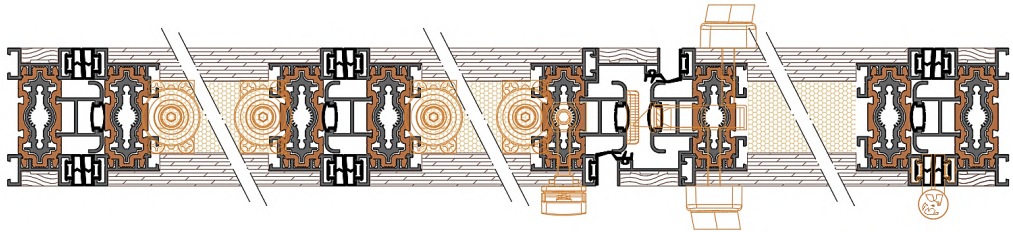

Center Hung

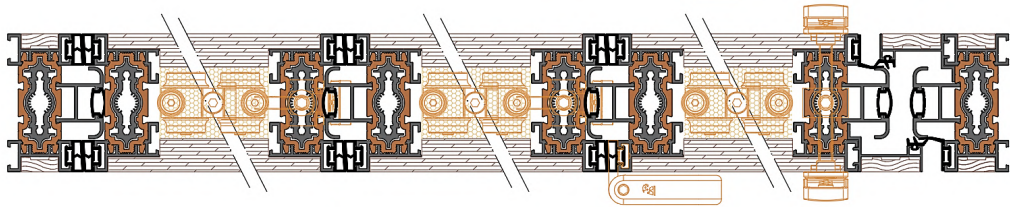

Center Fold

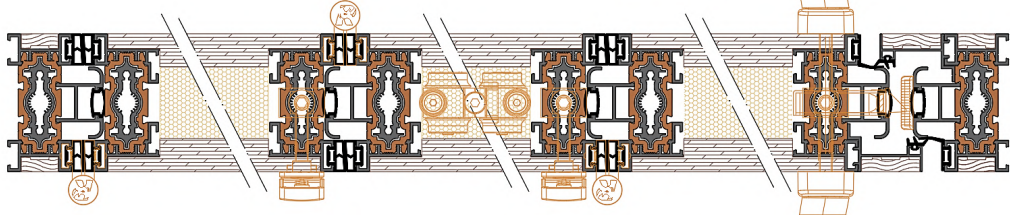

Bi-Folding

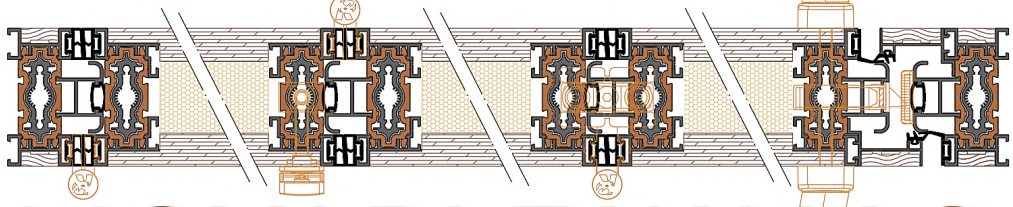

# MOVABLE WALLS

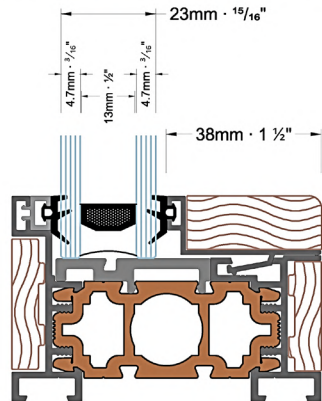
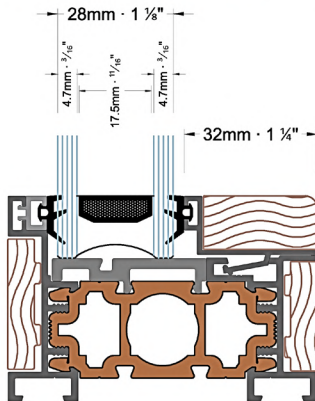
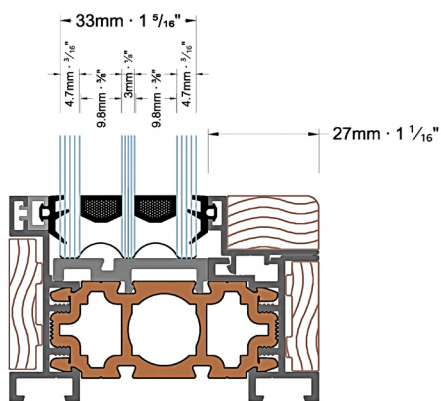
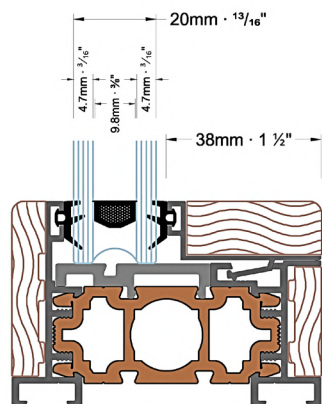
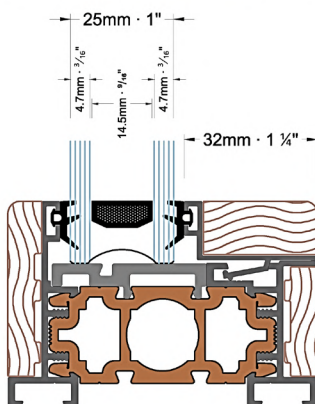
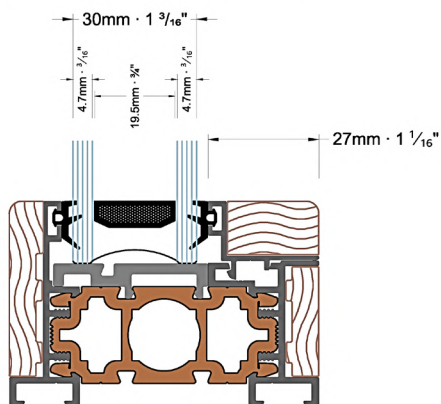
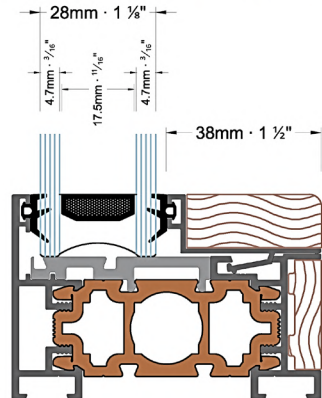
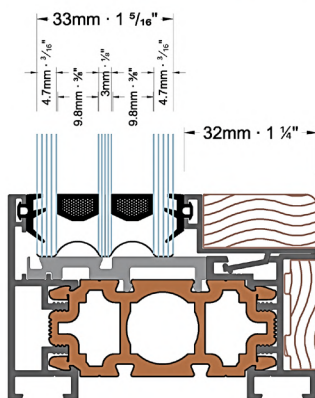
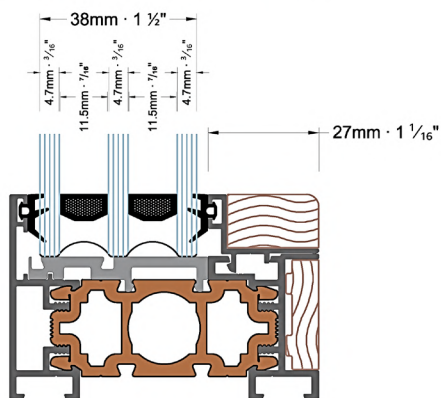
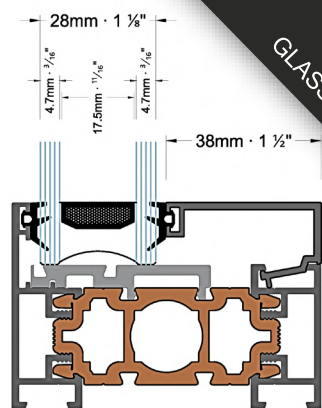
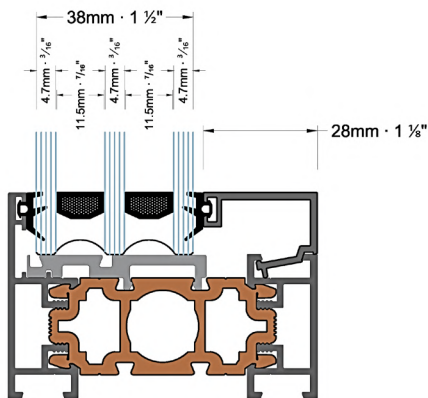
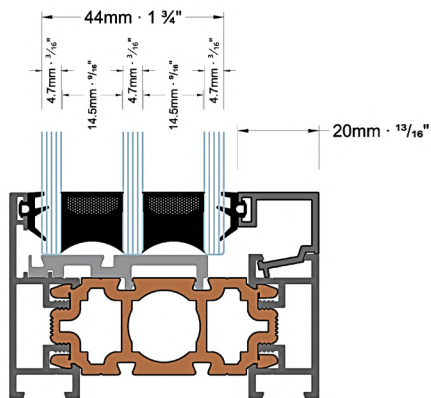

# APPENDIX

## HOW DO YOU OPEN THAT SPACE TO INCORPORATE A RHINOTRUSION DOOR?

The first thing that you need is an opening to accommodate the door, the opening must be of sound structure to allow it to be installed correctly. The opening walls and floor must be constructed from structural timber, steel, brick, concrete or concrete block.

Width: Measurement from wall to wall of the prepared opening, then minus a tolerance of 10-20mm /  $\frac{3}{8}$ "- $\frac{3}{4}$ "

Height: Measured from the underside of the top support to the underside of the bottom track, then minus a tolerance of 10-20mm /  $\frac{3}{8}$ "- $\frac{3}{4}$ "

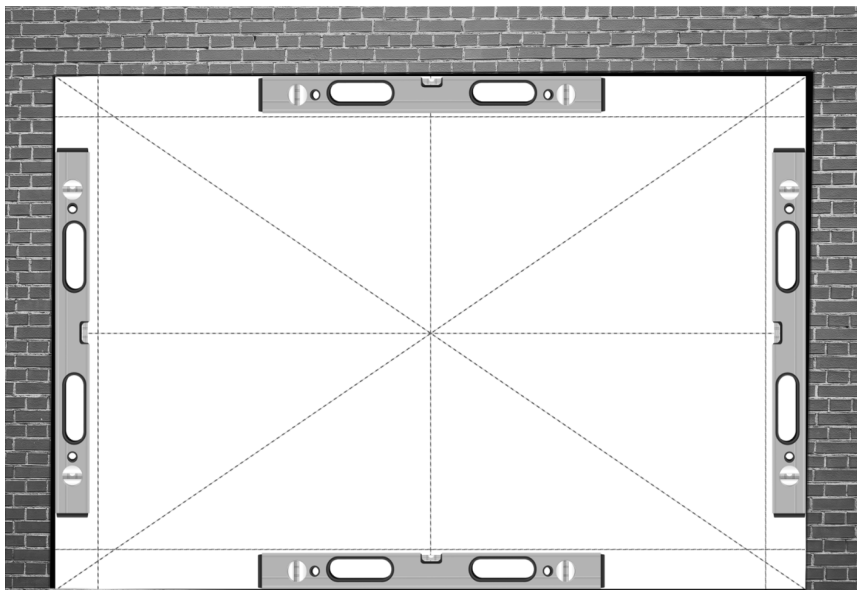

We recommend that you allow between 10-20mm /  $\frac{3}{8}$ "- $\frac{3}{4}$ " of tolerance between the opening structure and the door frame to allow ease of installation.

When measuring it is advisable to use a spirit level along with the tape measure to ensure the door is measured correctly.

Note: Always use the smallest measurement. Include your chosen threshold option in the frame in your *measurements and allow for floor finishes, tiles, carpet etc*

**Threshold:** When deciding the way that you would like your threshold to be situated, always make allowances in your measurement to accommodate the bottom track.

Note: The frame height includes the bottom track.

Once you have your opening size, you need to decide which direction you would like your door to open. Would you like it to open inward or outward? To the Left, Right or both ways?.

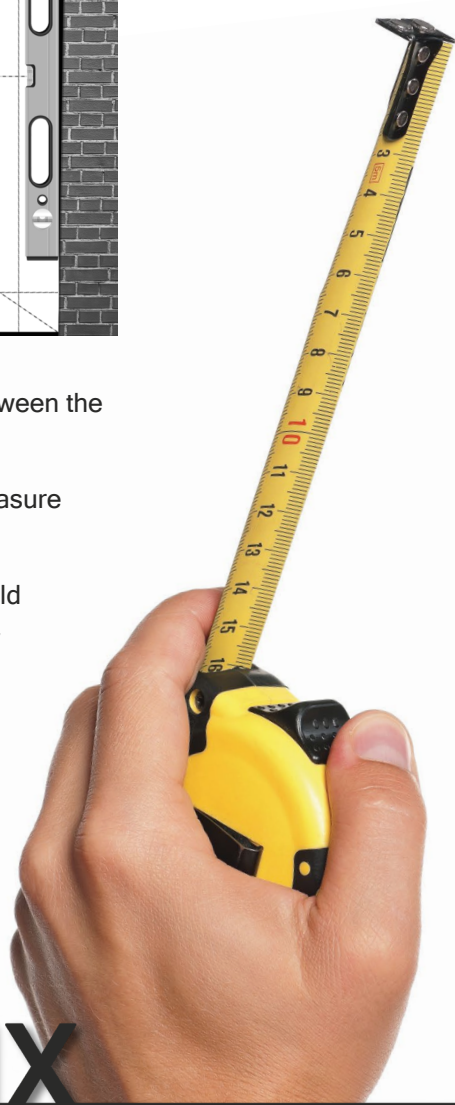

# APPENDIX

# BI FOLD DOOR - QUICK INSTALL INSTRUCTIONS

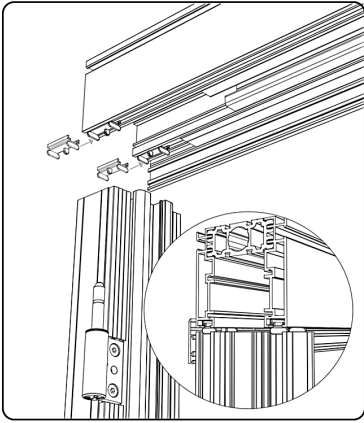

INSTALL RTPM07 JAMB LOCATORS

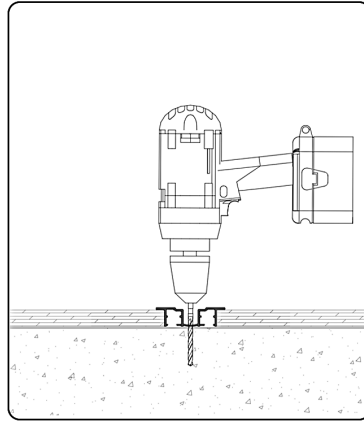

INSTALL BOTTOM TRACK LEVEL

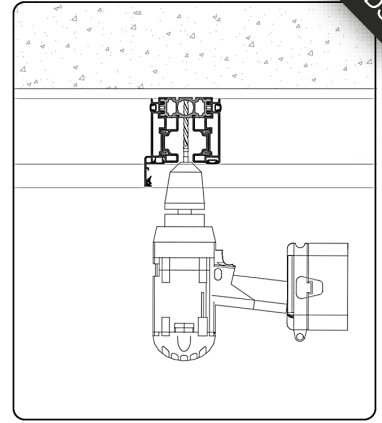

INSTALL TOP TRACK LOOSELY IN PLACE

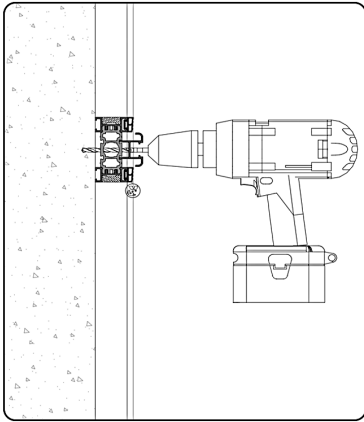

SITUATE JAMBS & FIX LEVEL

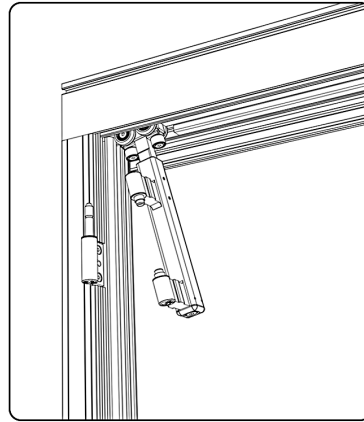

INSERT ROLLERS INTO TRACKS

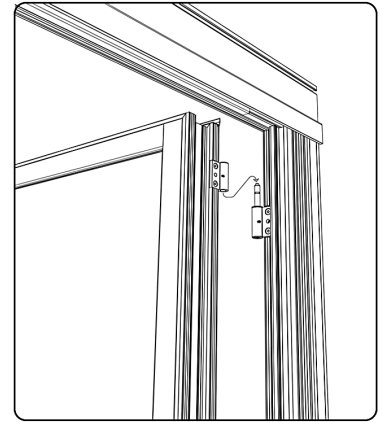

LIFT DOOR PANELS ONTO HINGES

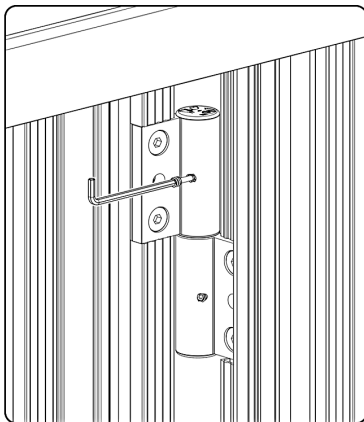

INSTALL HINGE PIN LOCKING SCREWS

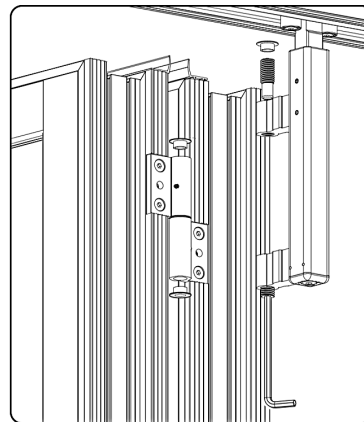

INSTALL ROLLERS ONTO HINGES

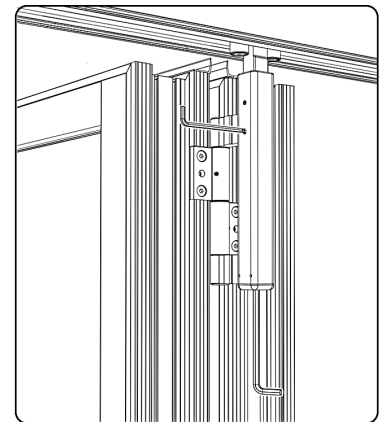

ADJUST ROLLERS & FRAME TO SUIT

# APPENDIX

# SLIDING DOOR - QUICK INSTALL INSTRUCTIONS

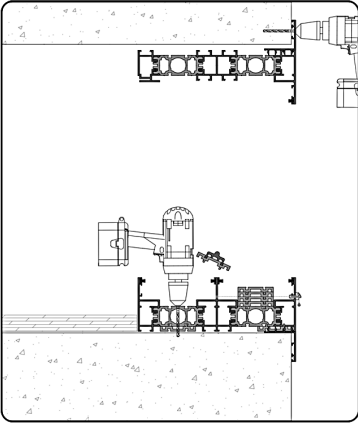

ASSEMBLE & INSTALL OUTER FRAME LEVEL

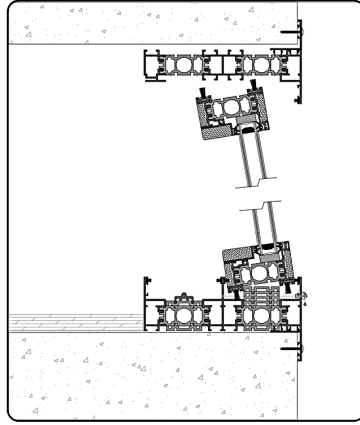

TILT BACK & INSTALL 1ST PANEL

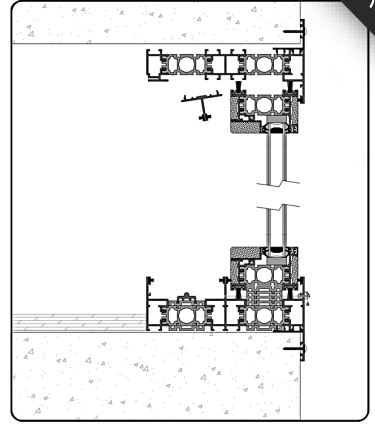

INSTALL THE TOP REBATE BAR

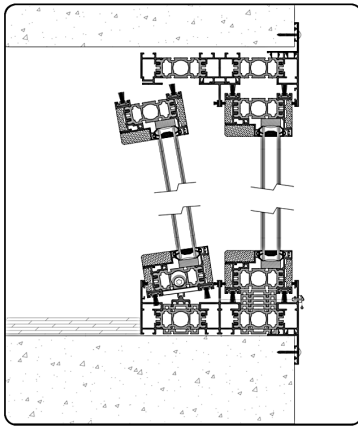

TILT BACK & INSTALL 2ND PANEL

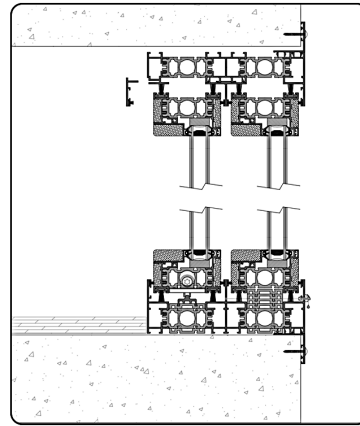

INSTALL THE TOP REBATE BAR

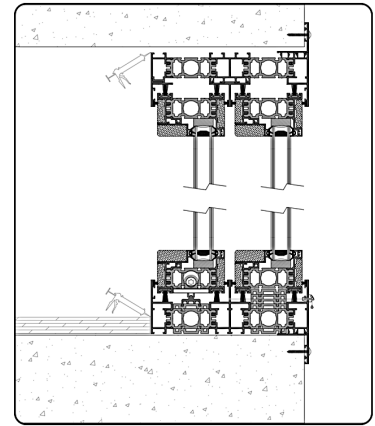

ADJUST DOOR FOR PERFECT RUNNING

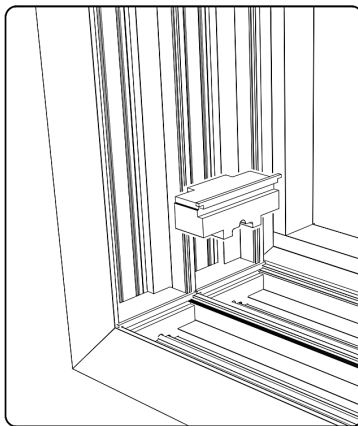

INSTALL FRAME COVER END CAPS



INSTALL SIDE JAMB COVERS

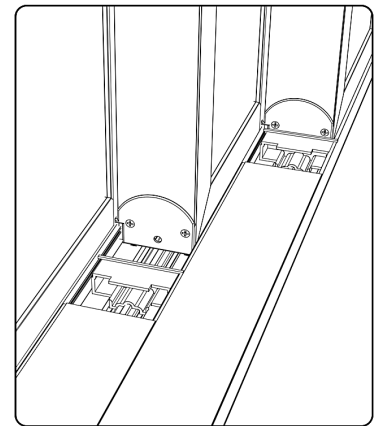

INSTALL TOP & BOTTOM COVERS

# APPENDIX

# COMMON MANUFACTURING / ASSEMBLY QUICK SHEET

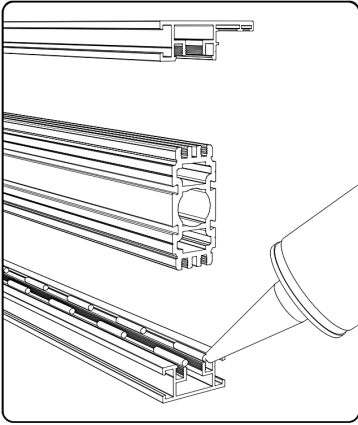

APPLY MEDIUM VISCOCITY URETHANE & ASSEMBLE

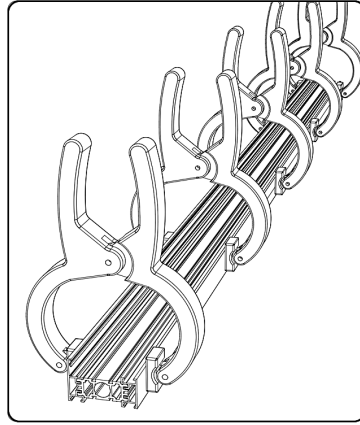

USE SPRING CAMPS UNTIL ADHESIVE CURES

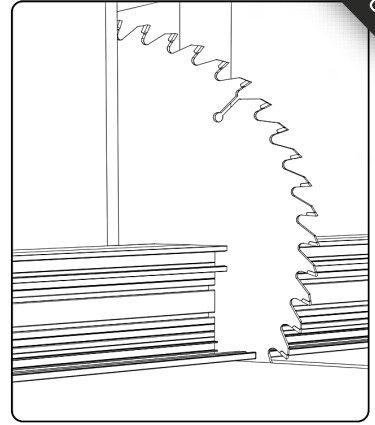

CUT ASSEMBLED PROFILES TO SIZE

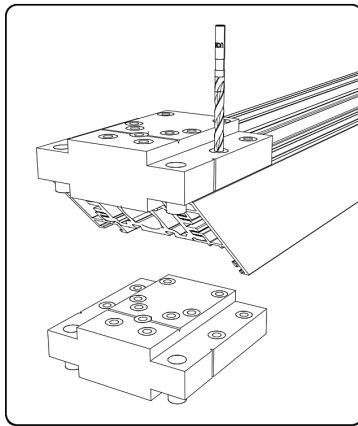

USE RTJ01 TO DRILL HOLES FOR CLEATS

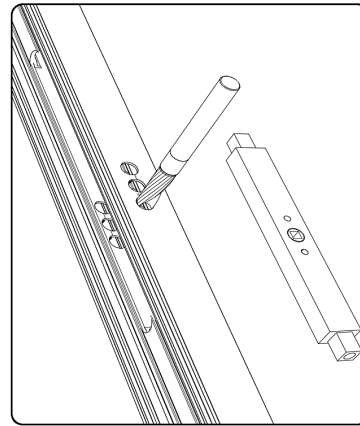

MACHINE FOR ALL HARDWARE / LOCKS

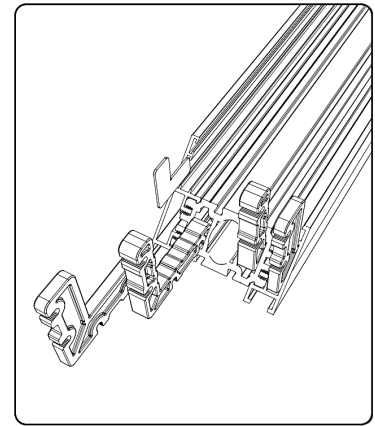

APPLY ADHESIVE & INSERT CORNER CLEATS

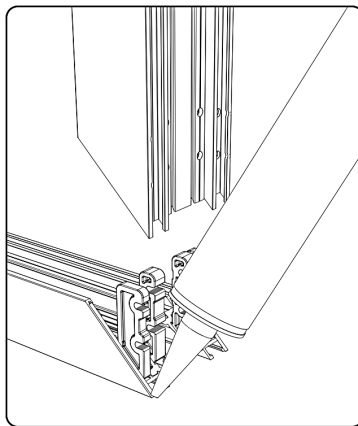

APPLY SEALANT TO CUT EDGES

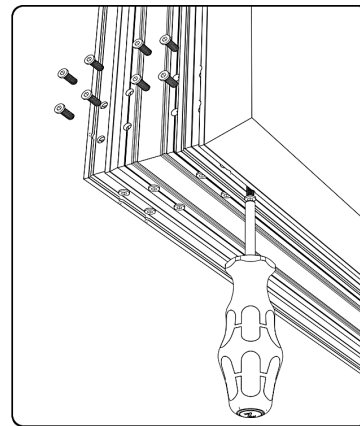

MOUNT CORNERS & WIPE EXCESS SEALANT

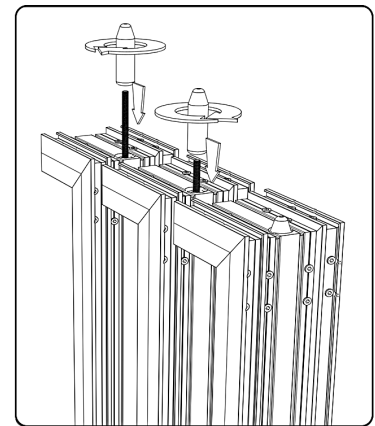

INSTALL HARDWARE, LOCKS & SEALS ETC...

# APPENDIX

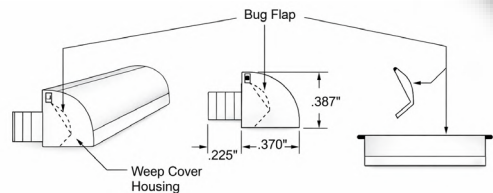

Drainage slot/hole size: 1" (25mm) x 1/4" (6mm)

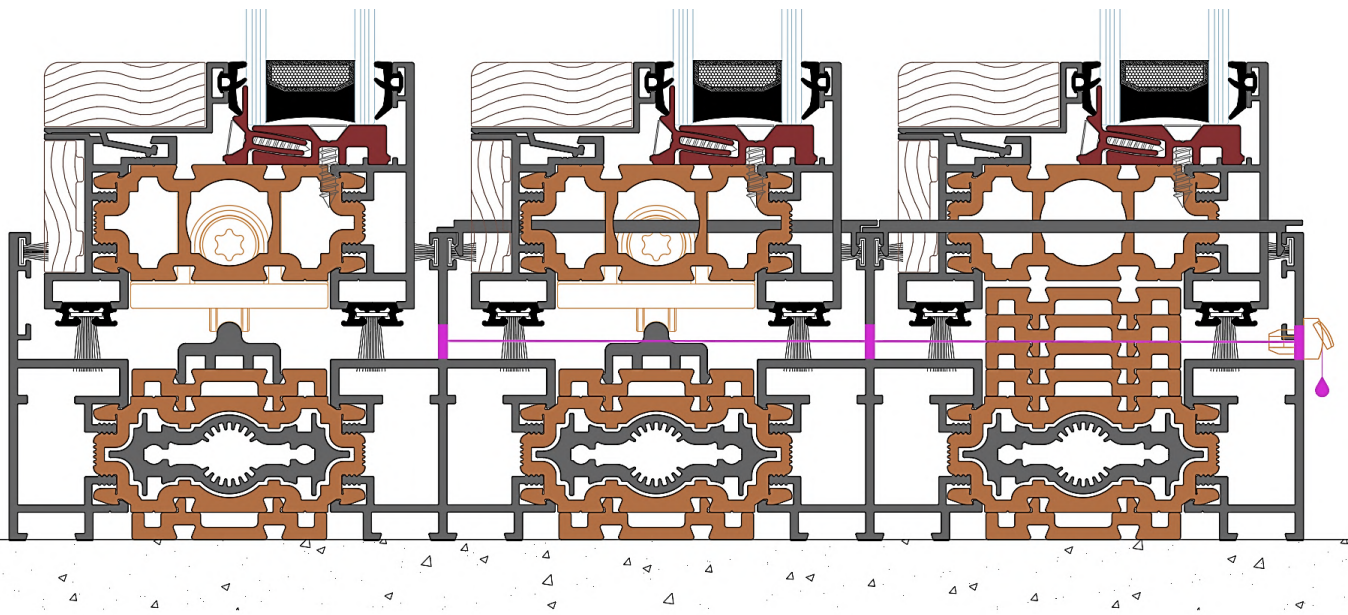
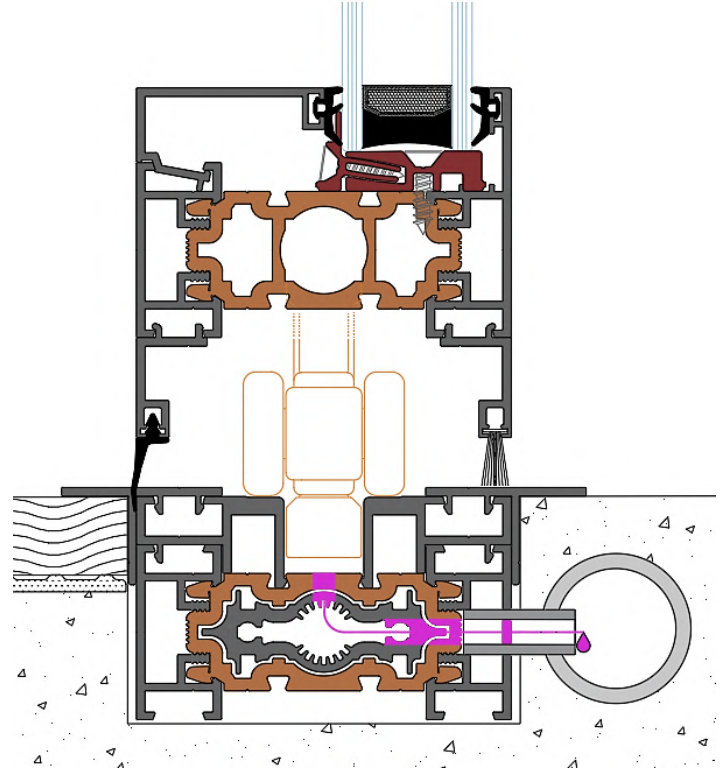
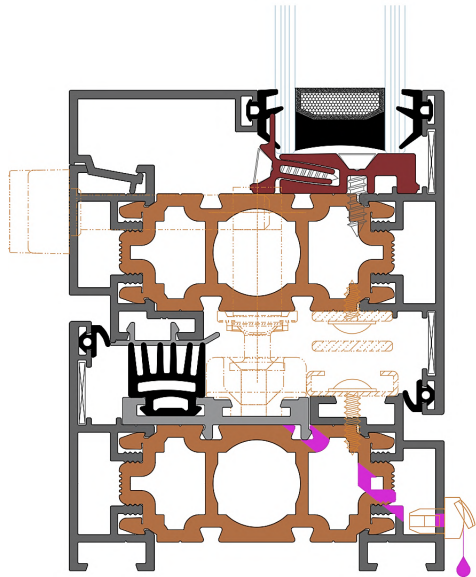
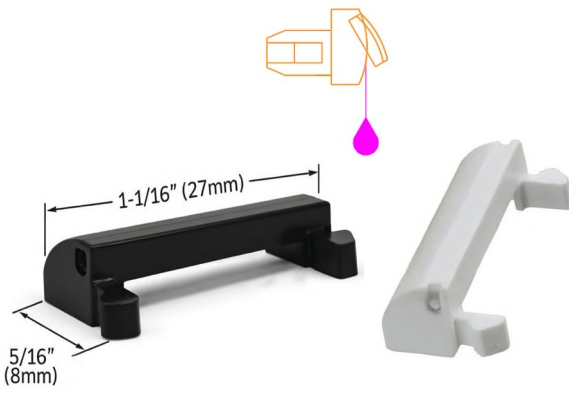

# APPENDIX

DRAINAGE



9241 White Plastic



9242 Sand Plastic



9243 Gray Plastic



9251 White Plastic



9252 Sand Plastic



9253 Gray Plastic



9261 White Plastic



9262 Sand Plastic



9263 Gray Plastic

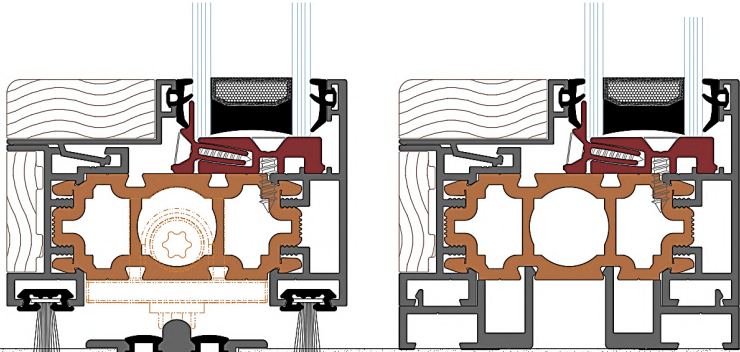

NDS 2 1/4-in X 6-ft Slim Channel Drain Kit

*This product suggestion is provided for illustrative purposes only*

57mm · 2 1/4"

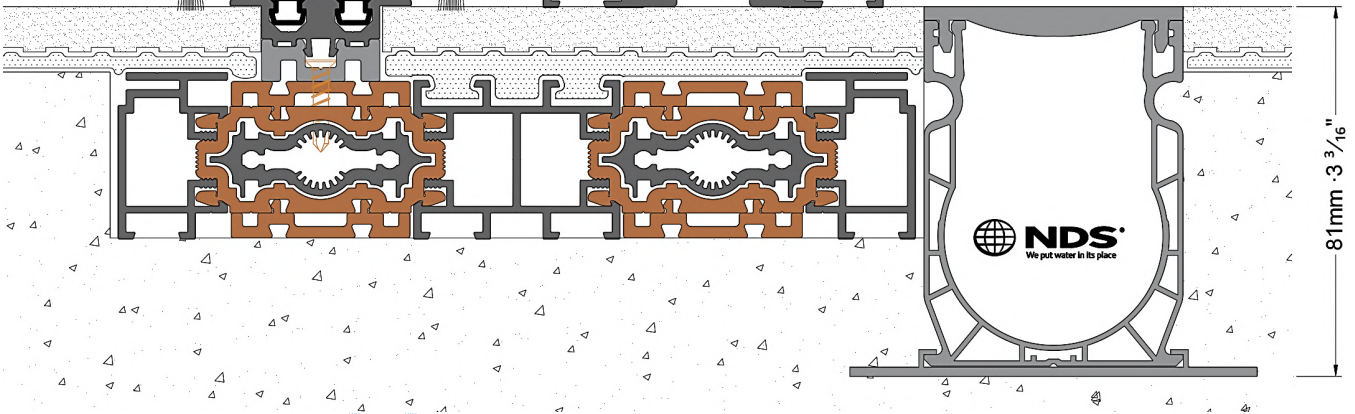

81mm · 3 1/16"

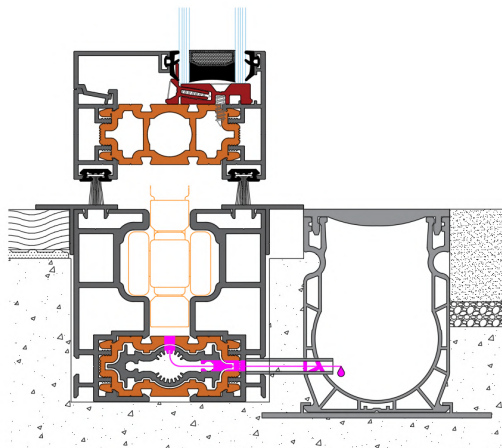
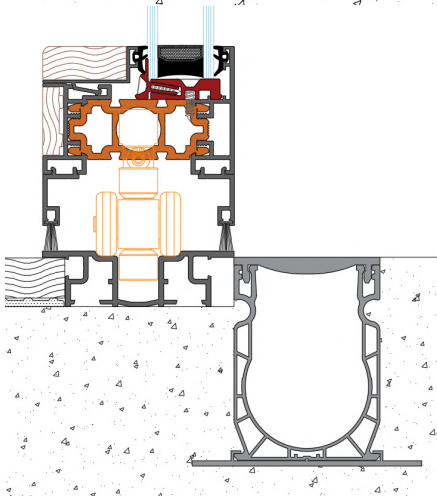

# APPENDIX

These are the main profiles and gaskets used to manufacture aluminum bi-folding and sliding doors. They include frames, sashes, tracks, glazing bead, and seals, all designed to work together for easy fabrication across different door configurations.

<p>RTA01 - Jamb &amp; Stile / Rail Internal</p>	<p>RTA02 - Stile / Rail External</p>	<p>RTA04 - Outer Frame Internal</p>	<p>RTA05 - Track Connector</p>	<p>RTA06 - 38mm Glazing Bead</p>	<p>RTA09 - Closer</p>
<p>RTA10 - Brush Carrier / Add-On</p>	<p>RTA11 - Rebate</p>	<p>RTA12 - Tongue</p>	<p>RTA14 - Low Profile Track</p>	<p>RTA16 - Track Adaptor</p>	<p>RTA17 - Flush Track Adaptor</p>
<p>RTA18 - Track Runner</p>	<p>RTA19 - Inner Track Connector</p>	<p>RTA20 - Interlocker Cover</p>	<p>RTA21 - Track Cover</p>	<p>RTA28 - Combination Track Connector</p>	<p>RTA29 - Slider Top Track Rebate Receiver</p>
<p>RTA30 - Slider Top Track Rebate</p>	<p>RTA34 - 75 FSD Track</p>	<p>RTA35 - 75 Re-Enforcement</p>	<p>RTTB05 - Profile Core / Thermal Break</p>	<p>RTTB07 - Profile Core / Thermal Break</p>	<p>RTG01 - Panel Gasket</p>
<p>RTG08 - Closer / Glazing Gasket</p>	<p>RTG05 - Panel Flipper Gasket</p>	<p>RTG06 - Tongue Infill Gasket</p>	<p>RTP01 - Interlocker Seal</p>	<p>RTP04 - 40mm Packer Strip</p>	<p>RTP06 - Glass Retainer</p>



# APPENDIX

ROLLERS

RTRO4

RTRO3

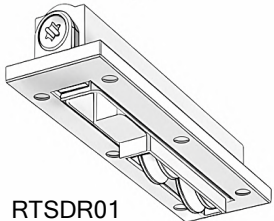

RTSDR01

RTR01

RTRG01

RTRCO1

CORNER CLEATS

RTCC01

RTCC02

RTCC05

RTCC04

RTCC03

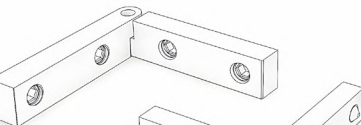

RTCC06 FLEXIBLE CLEAT

HINGES

RTHH01

RTH01

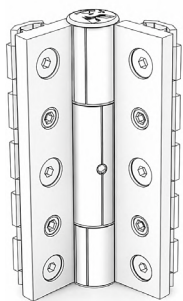

RTH02

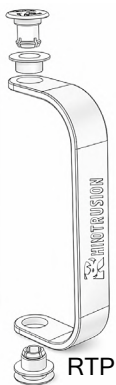

RTPH01



PLASTIC MOLDS

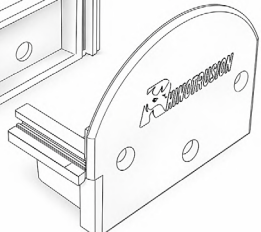
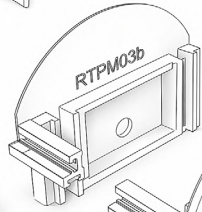
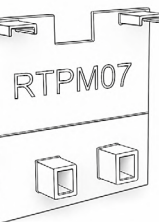
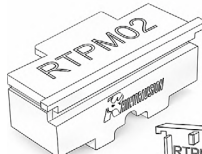

HANDLES & LOCKS



RTFH01

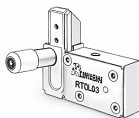
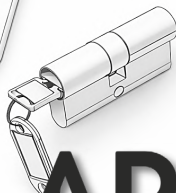

RTDL03



RTDL01

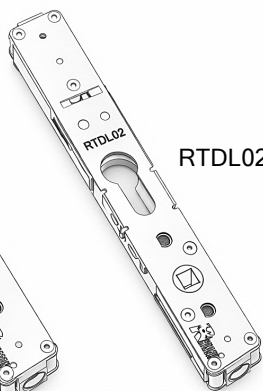

RTDL02

APPENDIX

RHINOLINQ is Rhinotrusion’s fully integrated digital support environment, developed specifically for window and door manufacturers. It centralizes technical, commercial, and production tools into a single, streamlined platform—giving fabricators complete operational visibility and control.

Accessible from any device—desktop, tablet, or mobile—RHINOLINQ operates entirely in the cloud, allowing your team to connect with Rhinotrusion systems anytime, from any location, without software limitations.

Core Capabilities:

- Centralized technical documentation (catalogs & system manuals)
- Detailed technical data sheets for all profiles and components
- Integrated quoting and pricing tools
- Real-time online stock ordering
- Automated bill of materials (BOM) generation and costing
- Advanced material optimization to reduce waste and improve yield
- Precision cutting lists and production sheets
- Profile section libraries with AutoCAD export compatibility

RHINOLINQ is designed to simplify workflows, reduce errors, and accelerate production—providing manufacturers with a scalable digital backbone to support growth and efficiency.



# APPENDIX



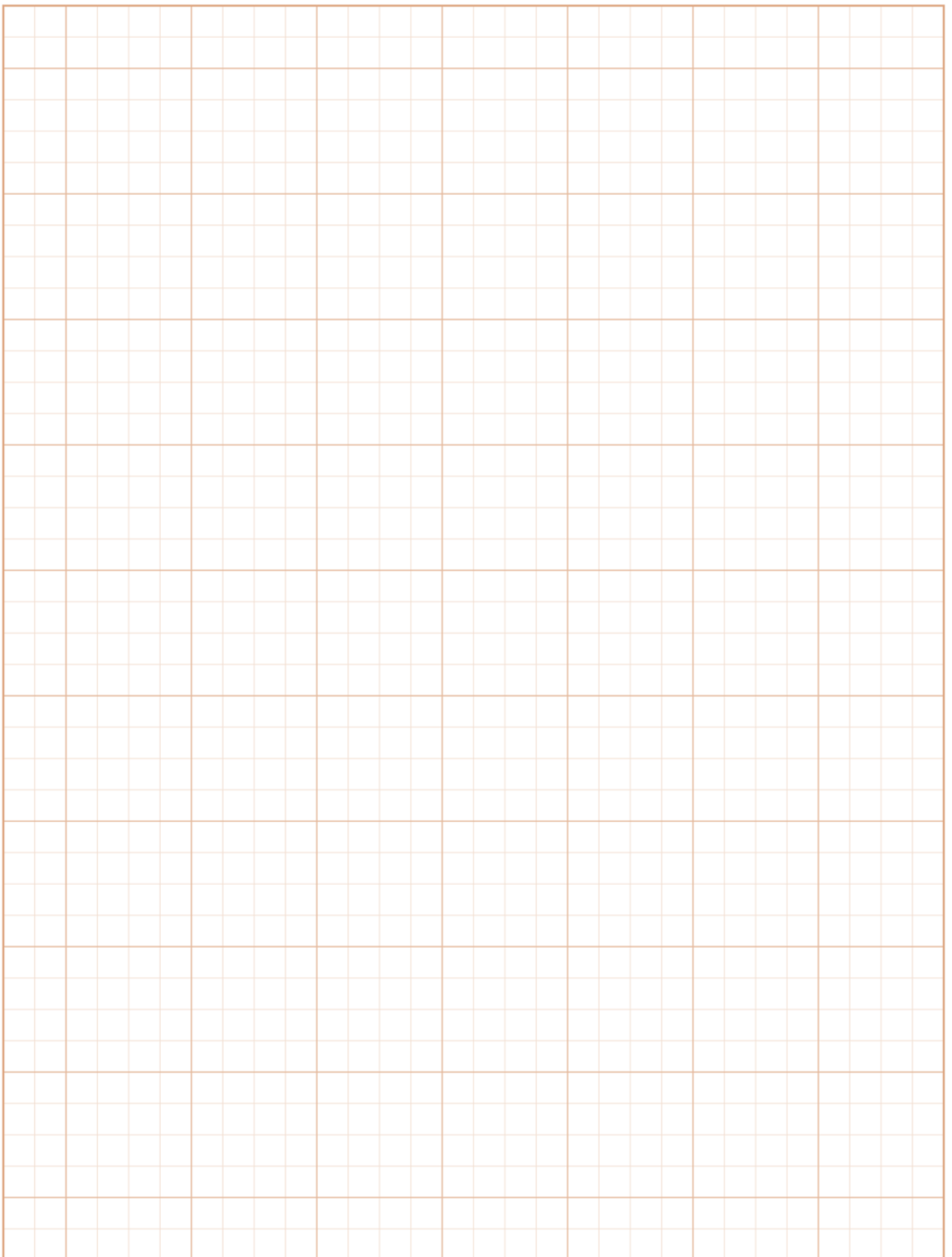

# Setting New Heights: Expanding Your Offering, Elevating Your Business

In a competitive window and door market, differentiation drives growth. Manufacturers that offer broader system options, flexible configurations, and premium finishes secure stronger relationships and higher-value projects.

Partnering with us gives you immediate access to a versatile, performance-driven product portfolio—engineered systems covering sliding doors, windows, and more—without additional tooling or development investment.

You gain the capability to meet diverse project requirements, improve win rates, and position your business as a complete, high-performance manufacturer.

For manufacturers focused on growth and market leadership—this is a direct path to scaling your offering and strengthening your competitive edge.



[www.rhinotrusion.com](http://www.rhinotrusion.com)  
[sales@rhinotrusion.com](mailto:sales@rhinotrusion.com)

INVESTMENT OPPORTUNITIES AVAILABLE